

US6X4 2 1/2 -5 TON • 6X4

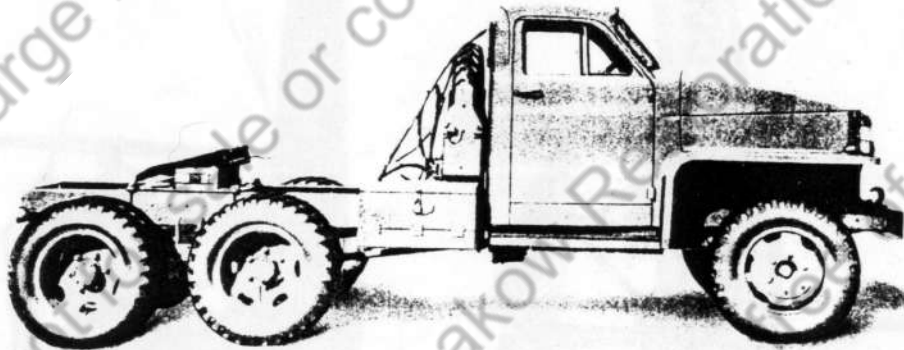

148" W.B. TRACTOR - With Steel Top Cab

TRUCK IDENTIFICATION

NUMBER OF VEHICLES ON CONTRACT	VEHICLE NOMENCLATURE	W.B.	CAB STYLE FROM
MODEL US6 2 1/2			
7000	CARGO LESS WINCH, WITH STEEL TOP CAB	162"	US6-1R955
4000	CARGO LESS WINCH, WITH SOFT TOP CAB	162"	
902	CARGO LESS WINCH, WITH SOFT TOP CAB	162"	US6-29957
3547	CARGO LESS WINCH, WITH STEEL TOP CAB	162"	
795	CARGO WITH WINCH, WITH STEEL TOP CAB	162"	
5600	CARGO WITH WINCH, WITH STEEL TOP CAB	162"	
1400	CARGO WITH WINCH, WITH STEEL TOP CAB	162"	US6-42191
9362	CARGO LESS WINCH, WITH STEEL TOP CAB	162"	
500	CARGO LESS WINCH, WITH STEEL TOP CAB	162"	
2926	CARGO WITH WINCH, WITH STEEL TOP CAB	162"	US6-55612
839	SPECIAL CHASSIS, WITH STEEL TOP CAB	162"	
210	REAR DUMP LESS WINCH, WITH STEEL TOP CAB	148"	US6-56212
70	REAR DUMP WITH WINCH, WITH STEEL TOP CAB	148"	
90	SIDE DUMP LESS WINCH, WITH STEEL TOP CAB	148"	
30	SIDE DUMP WITH WINCH, WITH STEEL TOP CAB	148"	US6-56212
15370	CARGO LESS WINCH, WITH STEEL TOP CAB	162"	
2700	CARGO WITH WINCH, WITH STEEL TOP CAB	162"	
2525	CARGO LESS WINCH, WITH STEEL TOP CAB	162"	
446	CARGO WITH WINCH, WITH STEEL TOP CAB	162"	

* FOR VEHICLES WITH REFRIGERATOR OR MACHINE SHOP BODY

MODEL US6x4 2

4000	CARGO LESS WINCH, WITH SOFT TOP CAB	162"	US6X4-1R17
2000	CARGO LESS WINCH, WITH STEEL TOP CAB	162"	
1000	CARGO LESS WINCH, WITH SOFT TOP CAB	162"	US6X4-2844
104	CARGO LESS WINCH, WITH STEEL TOP CAB	162"	
2682	CARGO LESS WINCH, WITH STEEL TOP CAB	162"	US6X4-3083
492	CARGO WITH WINCH, WITH STEEL TOP CAB	162"	
1088	TRACTOR LESS WINCH, WITH STEEL TOP CAB	148"	US6X4-3971
890	TRACTOR LESS WINCH, WITH STEEL TOP CAB	148"	
6534	CARGO LESS WINCH, WITH STEEL TOP CAB	162"	US6X4-416
2384	CARGO WITH WINCH, WITH STEEL TOP CAB	162"	
1884	TRACTOR LESS WINCH, WITH STEEL TOP CAB	148"	
10200	CARGO LESS WINCH, WITH STEEL TOP CAB	162"	
1800	CARGO WITH WINCH, LESS STEEL TOP CAB	162"	

ILLUSTRATIONS OF STUDEBAKER VEHICLES

**US6 2½ TON • 6X6
US6X4 2½ -5 TON • 6X4 ***



162" W.B. CARGO - With Steel Top Cab and 80"X144" Body

**US6 2½ TON • 6X6 •
US6X4 2½ -5 TON • 6X4**

* Identical in appearance
with 6X4 as illustrated
except for front axle.



162" W.B. CARGO - With Soft Top Cab and 80"X144" Body

PRINTED IN U.S.A.
12-43

PAGE NO. IV

US6 2½ TON • 6X6

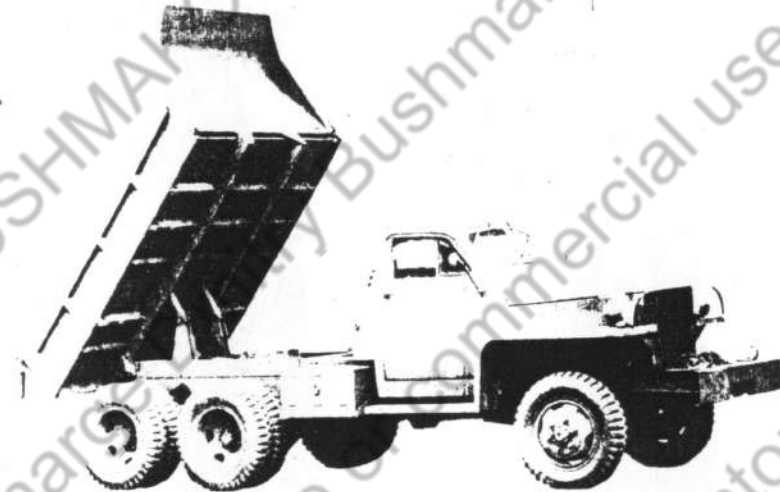

148" W.B. REAR DUMP - BODY UP - RIGHT SIDE - With Steel Top Cab

US6 2½ TON • 6X6



148" W.B. SIDE DUMP - BODY UP - LEFT SIDE - With Steel Top Cab

PAGE NO. V

PRINTED IN U.S.A.
12-43

01- ENGINE

PLATE 1

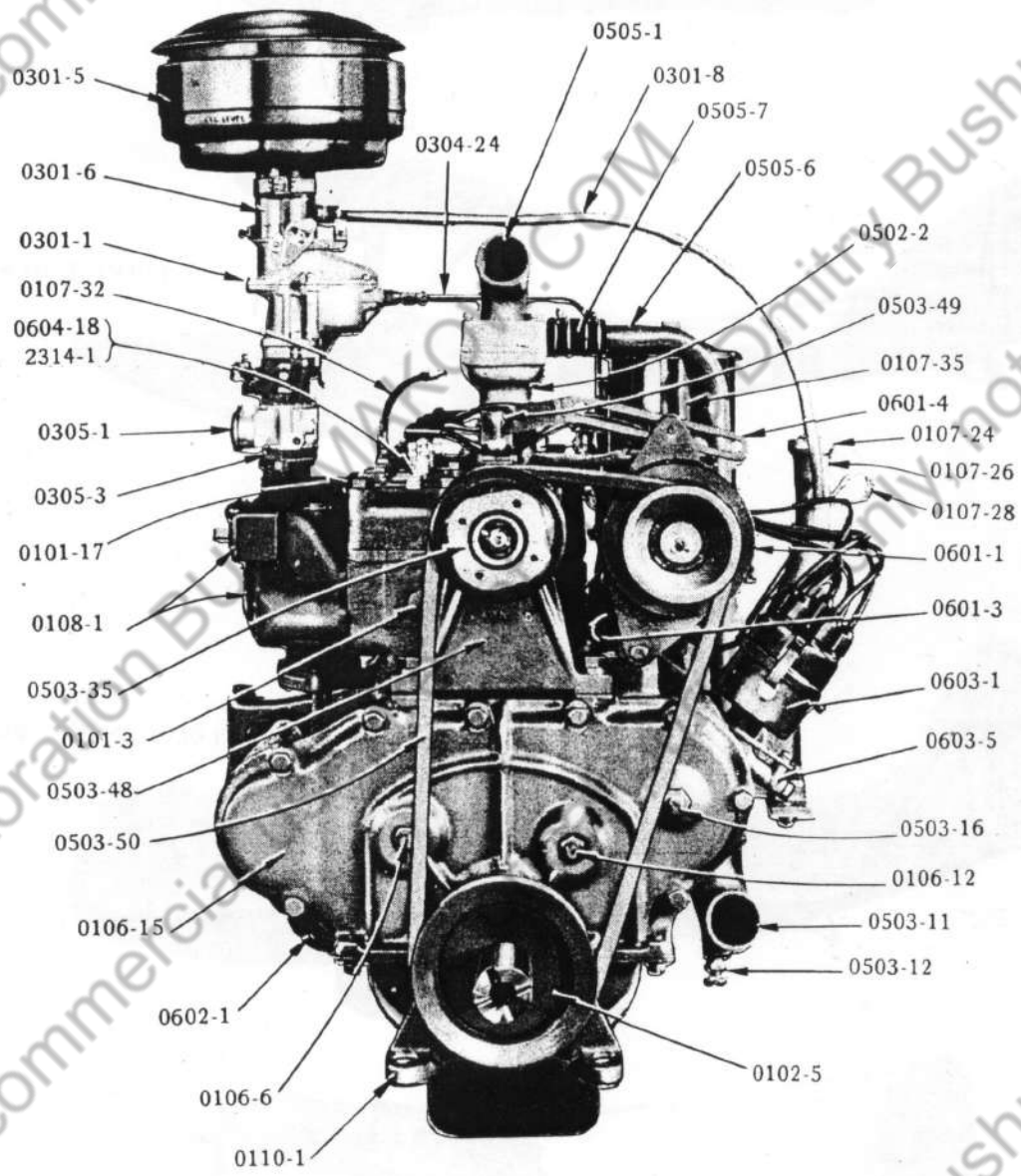

ENGINE - FRONT VIEW

PRINTED IN U.S.A.
12-43

PAGE NO. 2

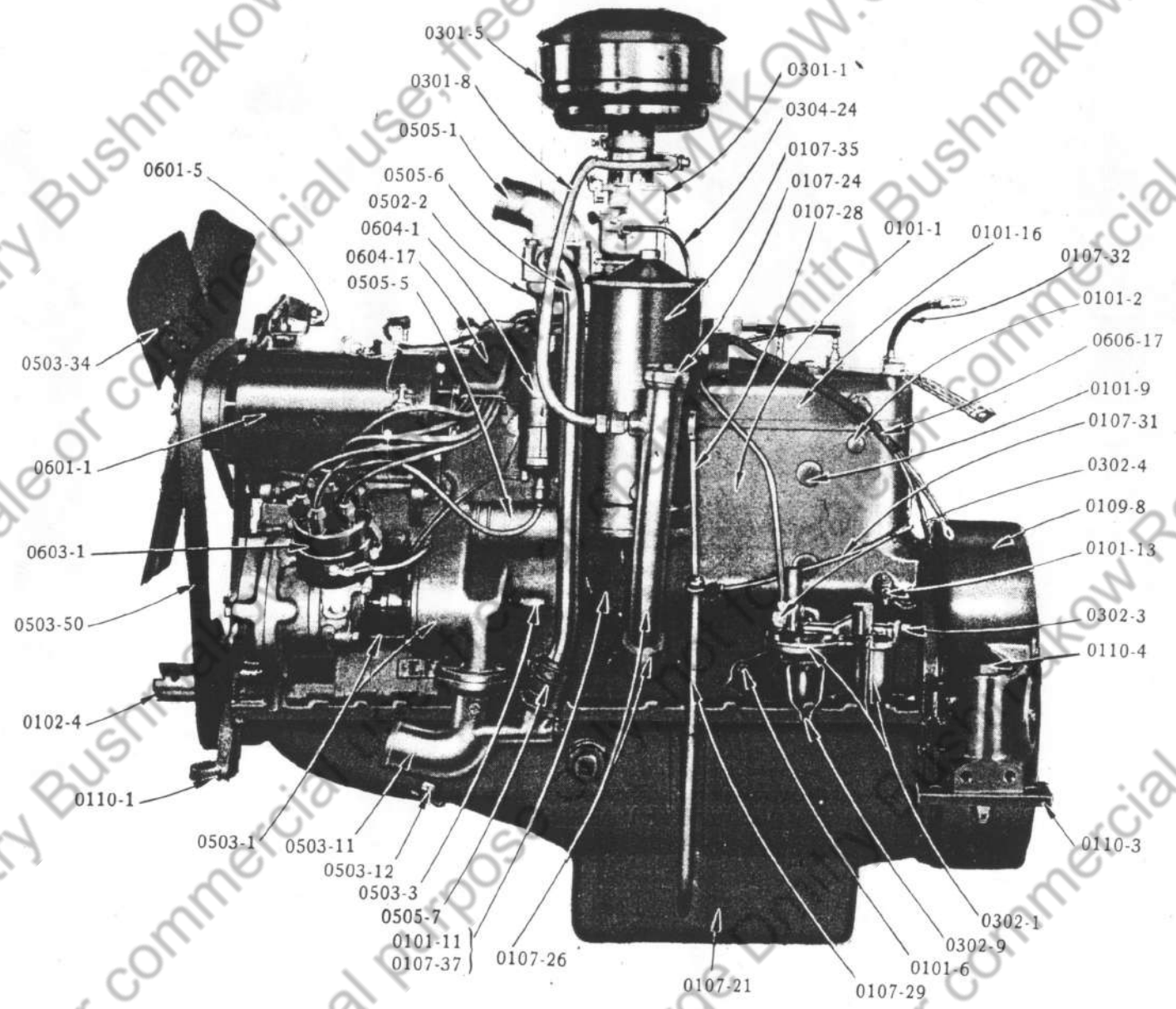

ENGINE - LEFT SIDE VIEW

PLATE 2

01

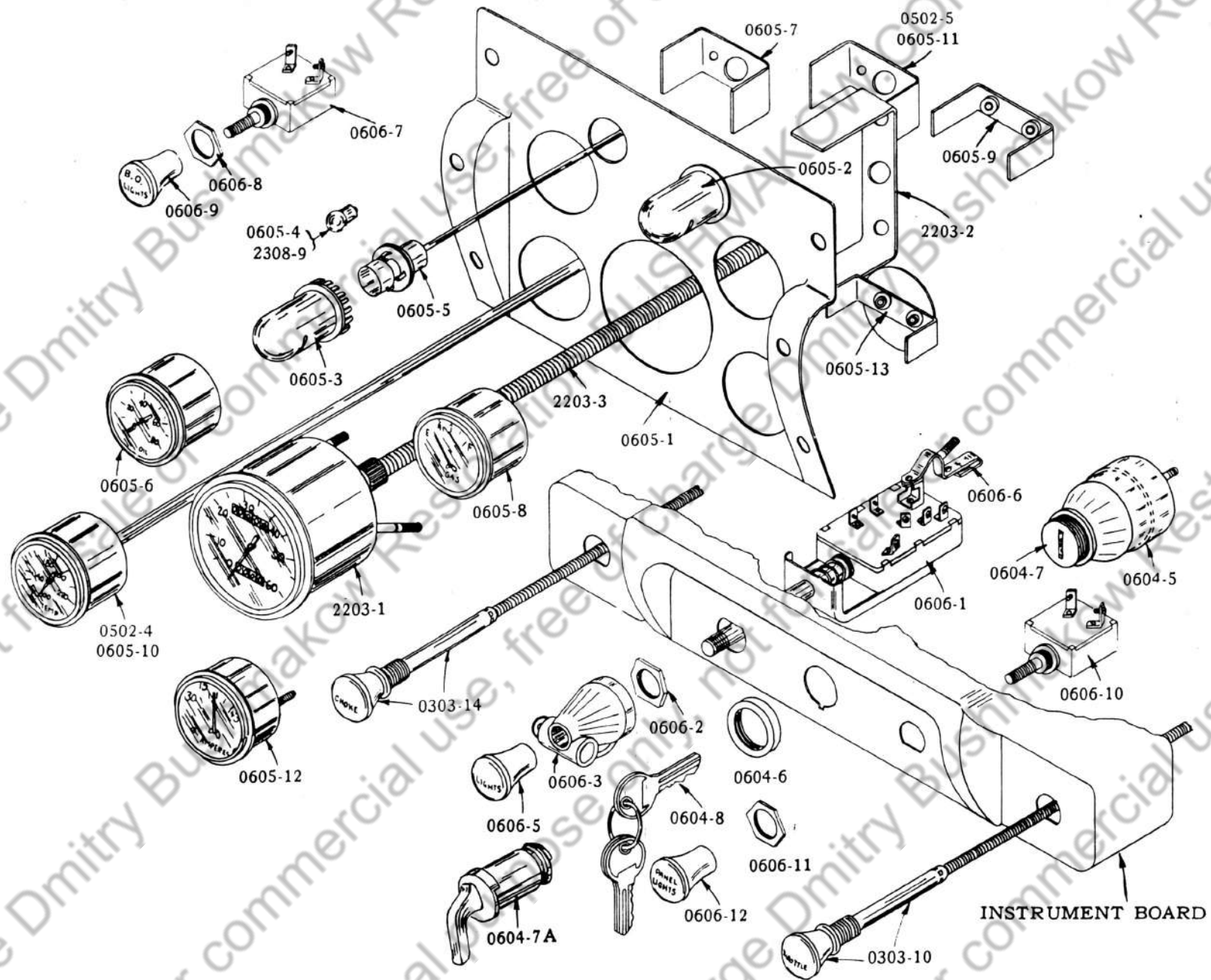

PAGE NO. 41

PRINTED IN U.S.A.
12-43

INSTRUMENT PANEL AND INSTRUMENTS (Used with Steel Top Cab)

PLATE 12

06

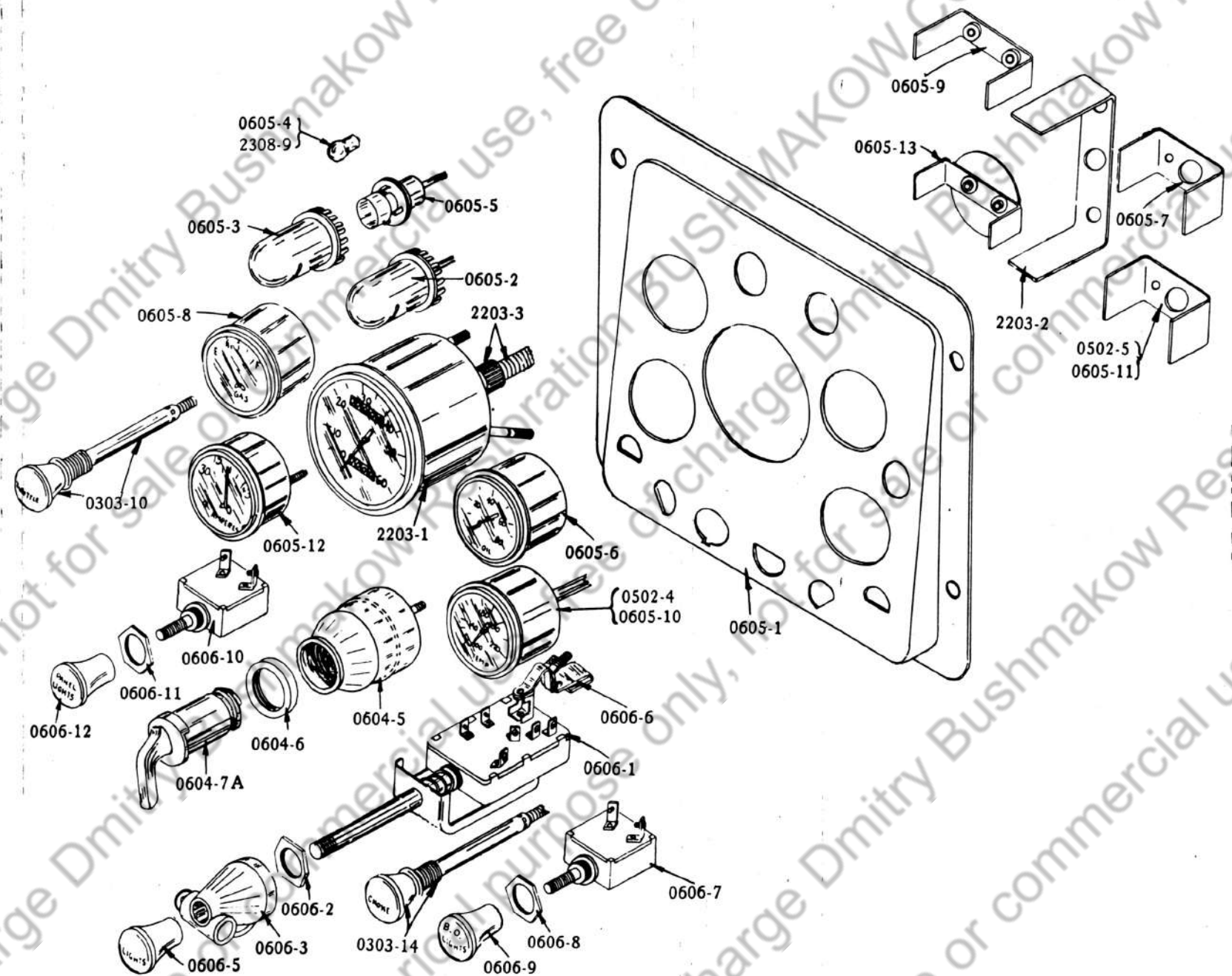
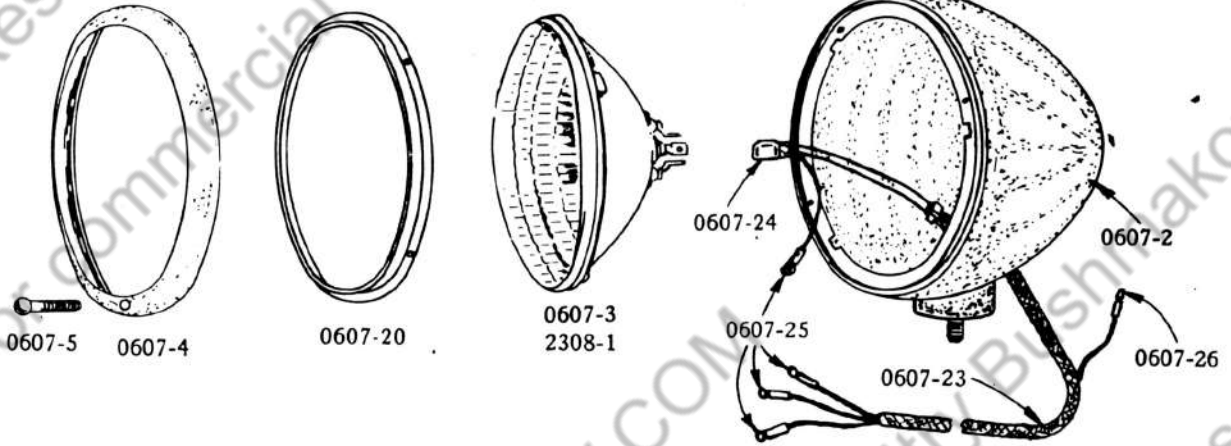

PLATE 13

INSTRUMENT PANEL AND INSTRUMENTS (Used with Soft Top Cab)

PLATE 14



SEALED BEAM HEADLAMP 0607-1

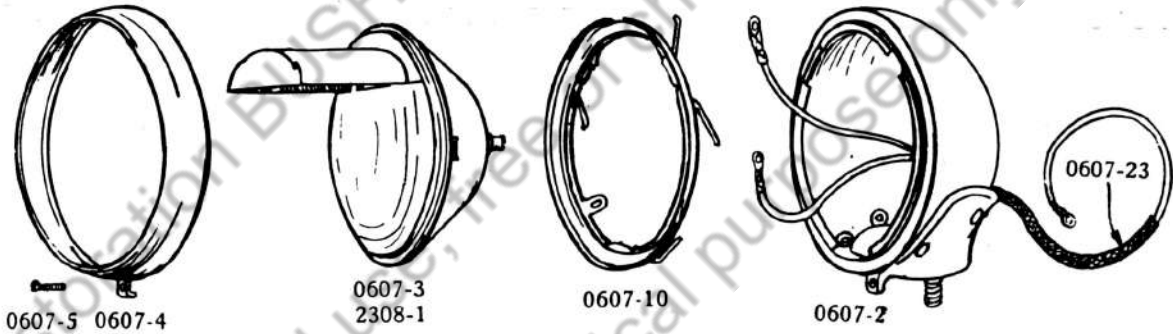

BLACKOUT HEADLAMP 0607-1

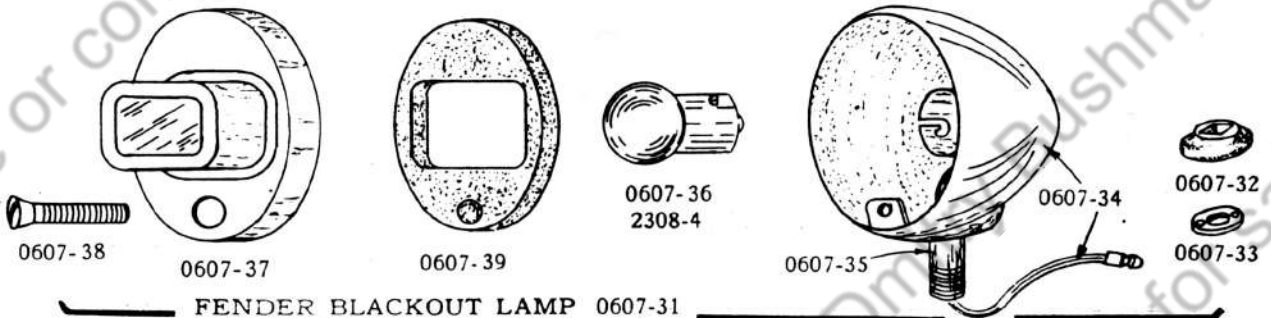

FENDER BLACKOUT LAMP 0607-31

HEAD AND FENDER LAMPS

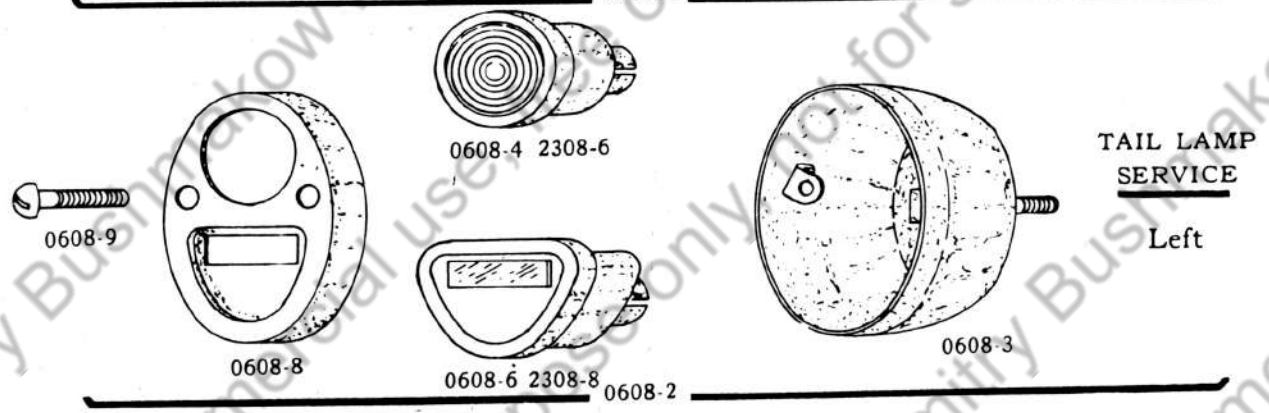
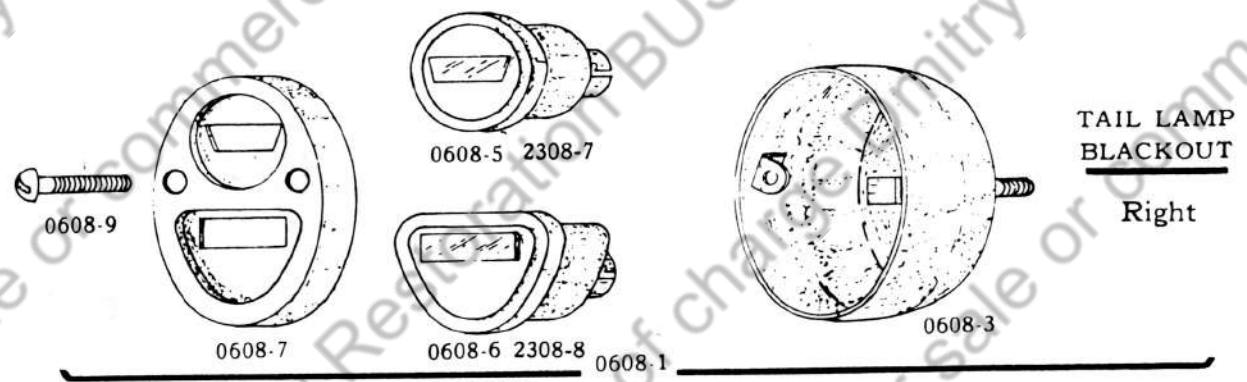

TAIL AND STOP LAMPS

RADIO INTERFERENCE SUPPRESSION

PLATE 17

BOND No.

LEGEND

- | | |
|---------|--|
| 1 & 2 | RADIATOR GUARD TO FRAME FRONT CROSS MEMBER - No. 1 AT LEFT SIDE OF GUARD -
No. 2 AT RIGHT SIDE OF GUARD |
| 3 | OIL PAN TO FRAME FRONT CROSS MEMBER |
| 4 | CYLINDER HEAD TO DASH |
| 5 | CLUTCH HOUSING TO ENGINE SUPPORT BRACKET |
| 6 | RIGHT FRONT FENDER APRON TO FRAME SIDE MEMBER - AT LOWER FRONT SECTION OF APRON |
| 7 | RIGHT FRONT FENDER APRON TO FRAME SIDE MEMBER - AT LOWER REAR SECTION OF APRON |
| 8 | LEFT FRONT FENDER APRON TO FRAME SIDE MEMBER - AT LOWER FRONT SECTION OF APRON |
| 9 | LEFT FRONT FENDER APRON TO BATTERY CRADLE |
| 10 & 11 | CAB TO FRAME - No. 10 AT LEFT REAR - No. 11 AT RIGHT REAR |
| 12 & 13 | HOOD TOP PANEL TO COWL - No. 12 AT RIGHT - No. 13 AT LEFT |
| 14 | RADIATOR GUARD TO CORE SUPPORT |
| 15 | RADIATOR CORE TO SUPPORT |
| 16 | FRONT FENDER APRON TO RADIATOR CORE SUPPORT |
| 17 | HOOD SIDE PANEL TO RADIATOR CORE SUPPORT |
| 18 | HOOD SIDE PANEL TO BODY |
| 19 | HOOD SIDE PANEL TO FENDER AND APRON |
| 20 | FRONT FENDER APRON TO COWL |
| 21 | FRONT FENDER TO RADIATOR CORE SUPPORT |
| 22 | CONTROL RODS ANTI-RATTLE SPRINGS |
| 23 | FRONT FENDER TO COWL |

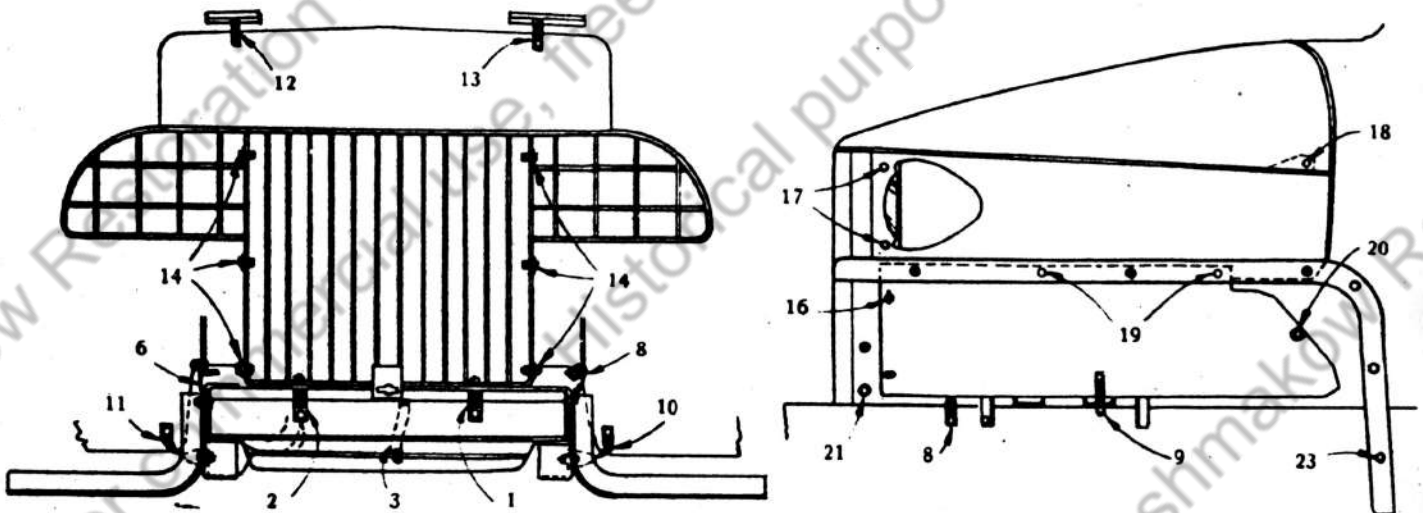

FRONT VIEW - RADIATOR GUARD AND HOOD SIDE VIEW - SHEET METAL

LOCATIONS OF BONDS

RADIO INTERFERENCE SUPPRESSION

06

PLATE 18

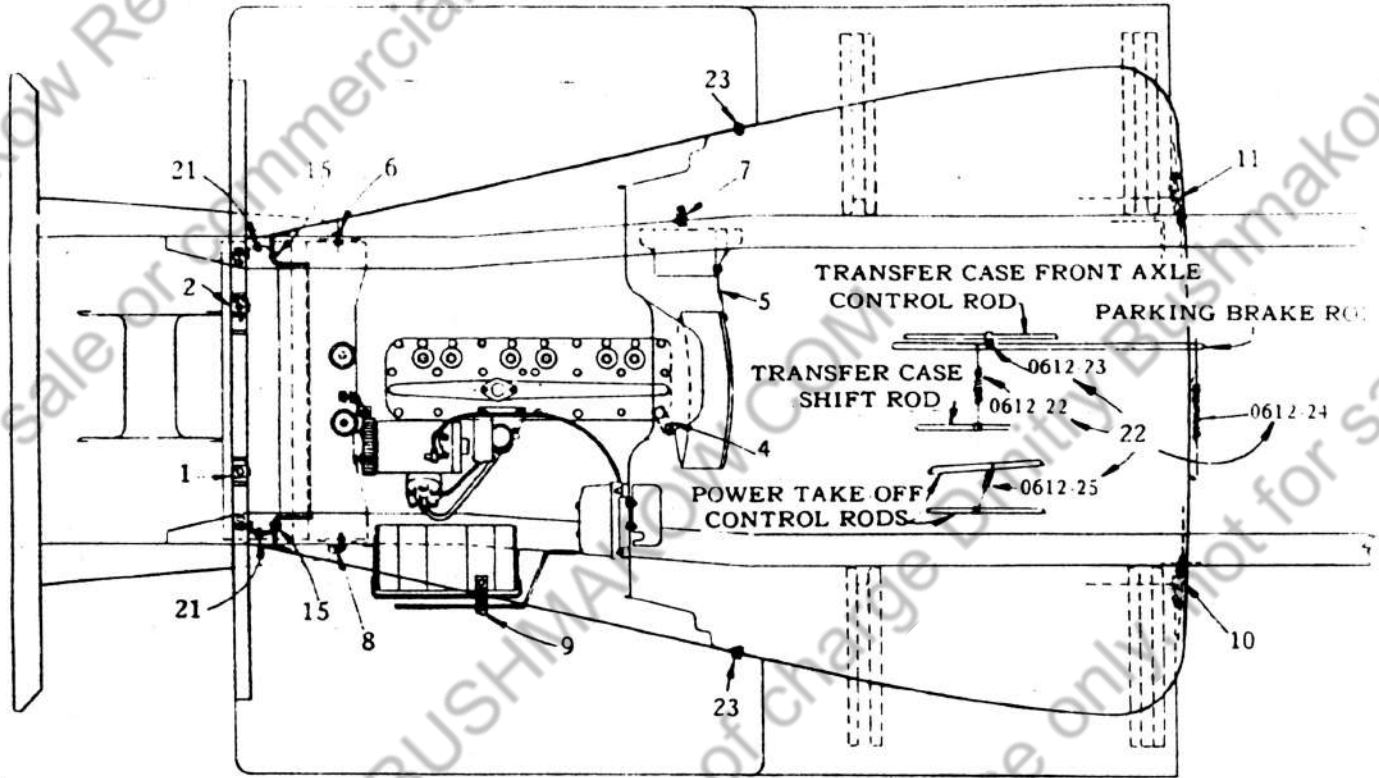

TOP VIEW - CHASSIS FRONT END AND CAB

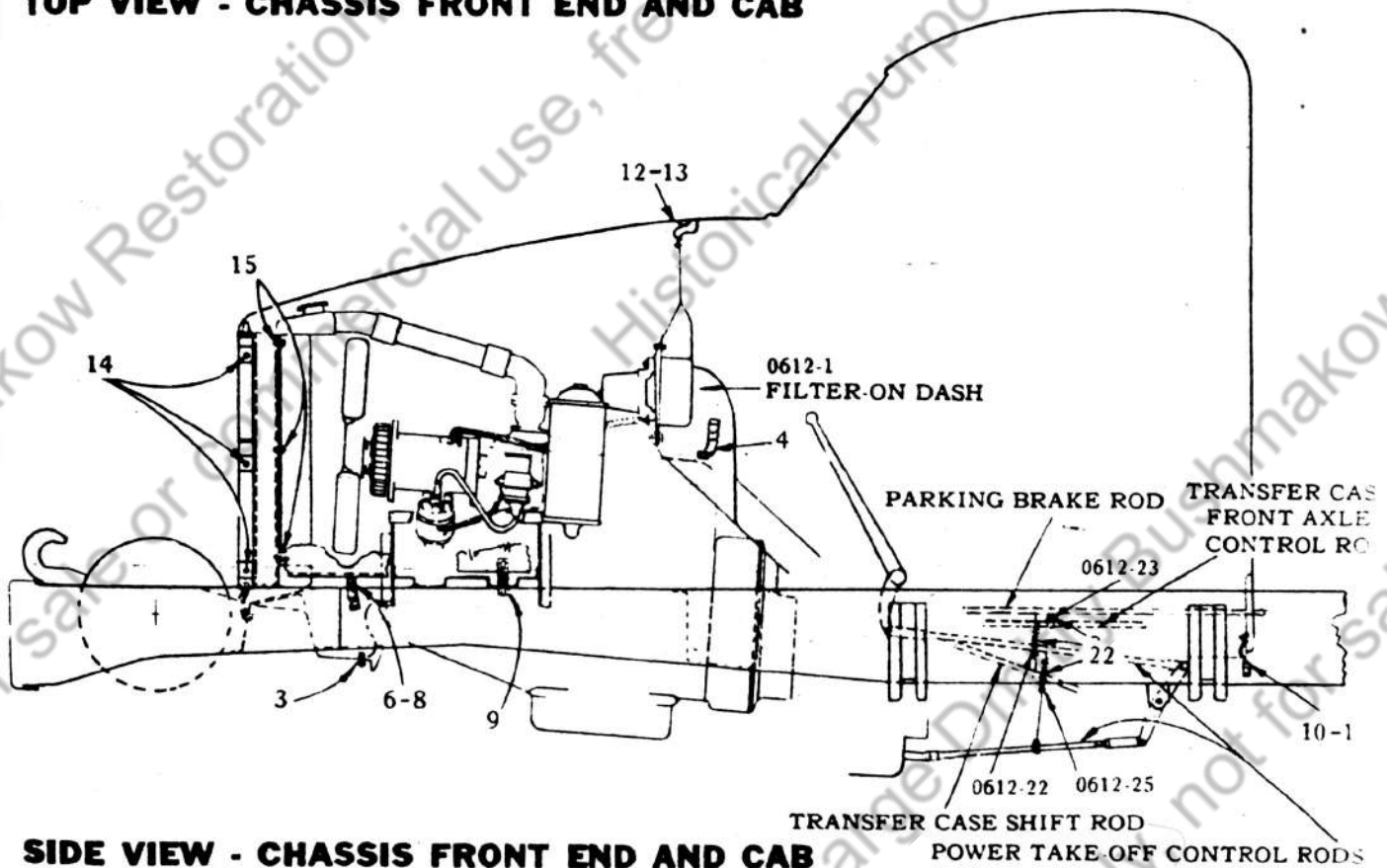

SIDE VIEW - CHASSIS FRONT END AND CAB

LOCATIONS OF BONDS

RADIO INTERFERENCE SUPPRESSION

PLATE 19

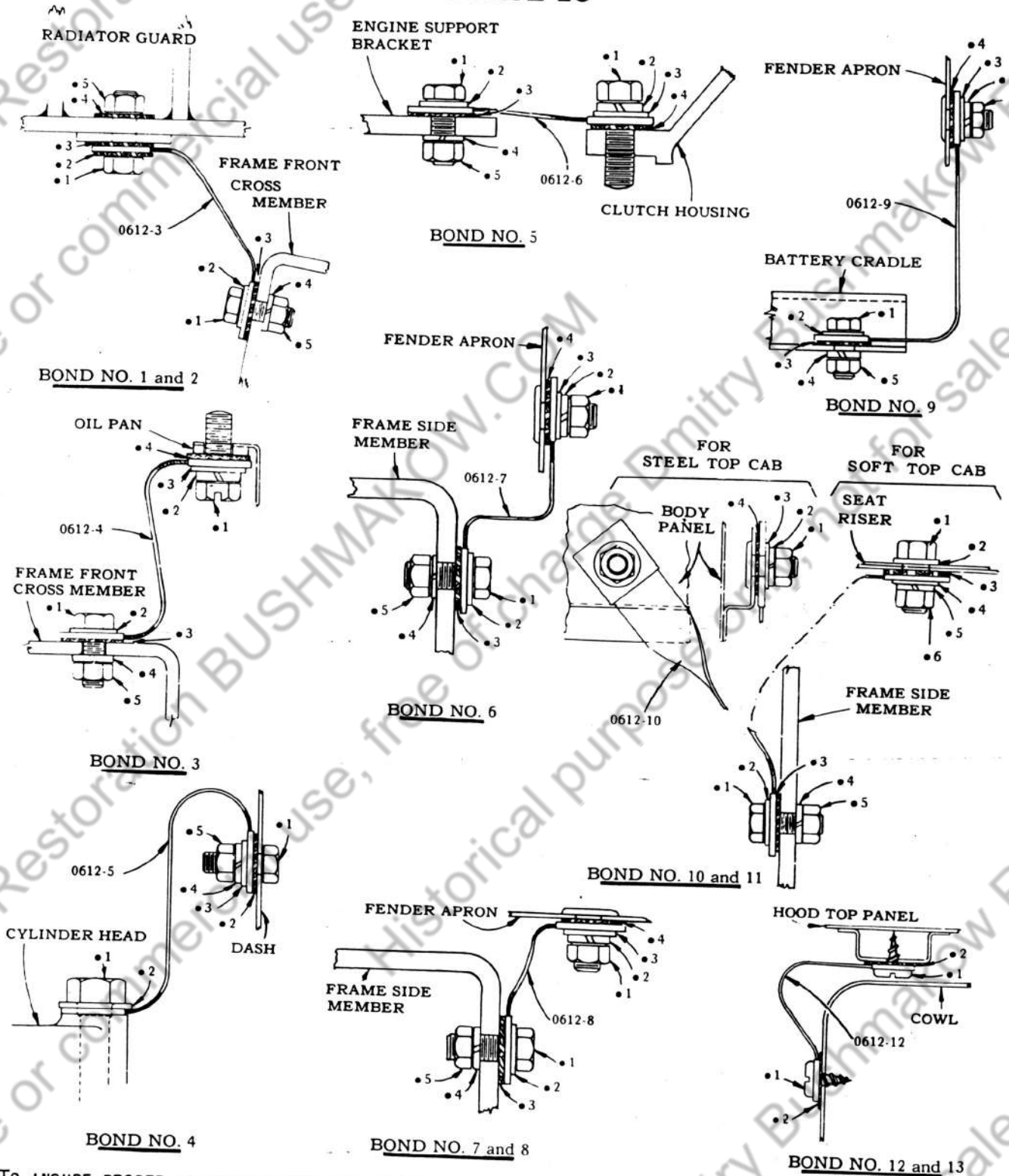

TO INSURE PROPER IDENTIFICATION AND INSTALLATION, FASTENING PARTS ARE LISTED IN THEIR RESPECTIVE GROUPS --- IN THE ORDER IN WHICH THEY ARE ASSEMBLED, AND ARE SO NUMBERED, VIZ., ●1, ●2, ●3, ETC.

DETAILS OF BONDS

RADIO INTERFERENCE SUPPRESSION

06

PLATE 20

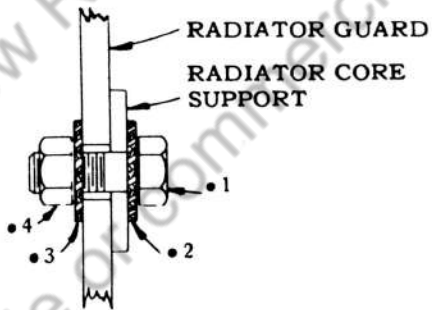

BOND NO. 14

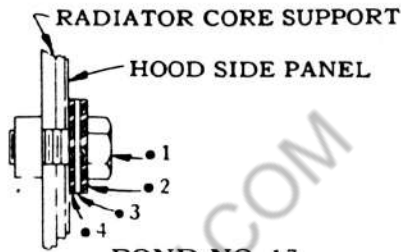

BOND NO. 17

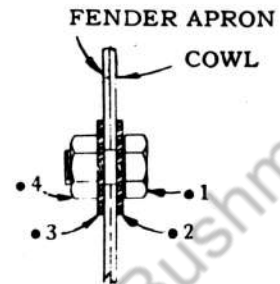

BOND NO. 20

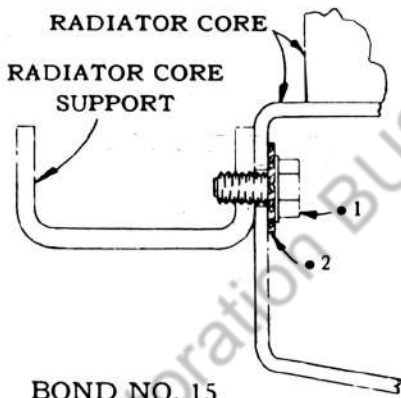

BOND NO. 15

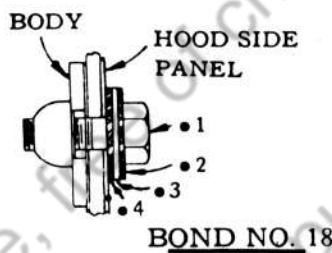

BOND NO. 18

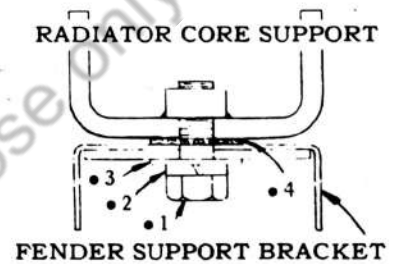

BOND NO. 21

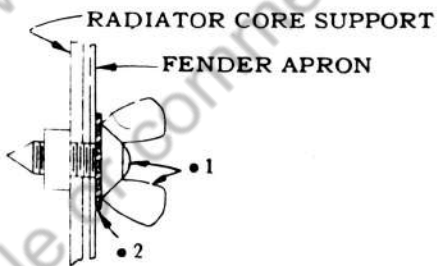

BOND NO. 16

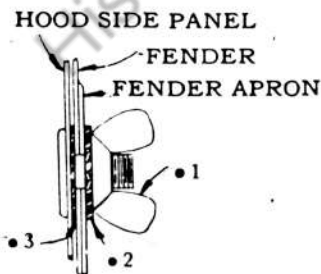

BOND NO. 19

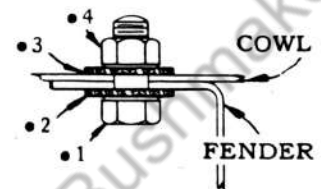

BOND NO. 23

TO INSURE PROPER IDENTIFICATION AND INSTALLATION, FASTENING PARTS ARE LISTED IN THEIR RESPECTIVE GROUPS --- IN THE ORDER IN WHICH THEY ARE ASSEMBLED, AND ARE SO NUMBERED, VIZ., •1, •2, •3, ETC.

DETAILS OF BONDS

09

09- PROPELLER SHAFT AND UNIVERSAL JOINT

PLATE 27

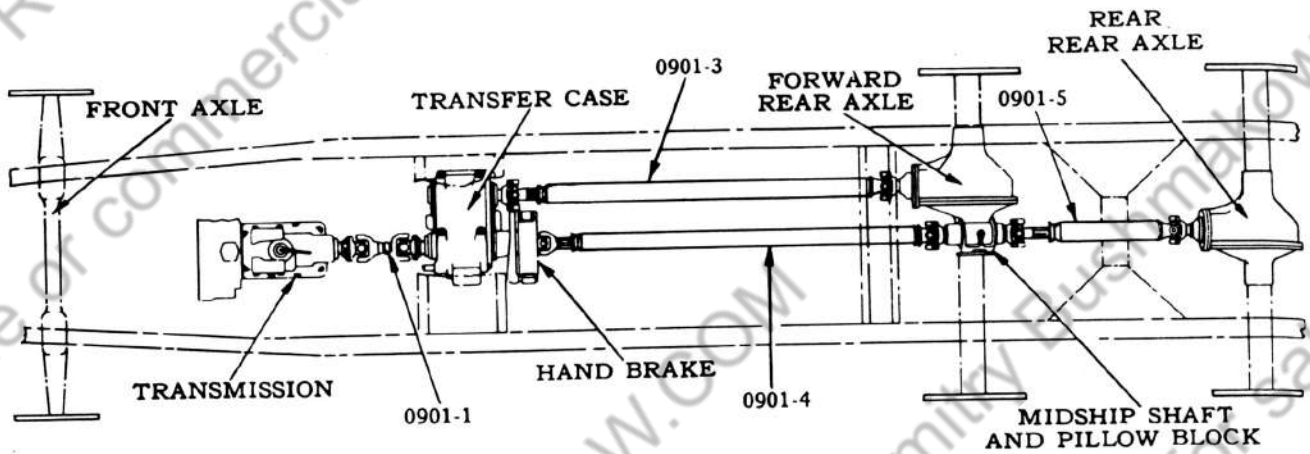

FOR 6X4

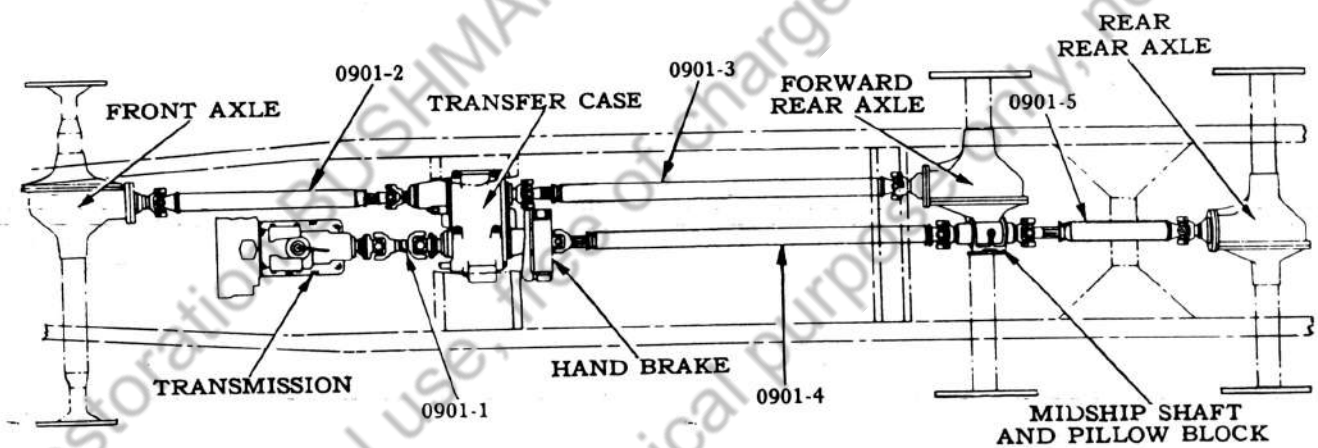

FOR 6X6

LOCATION OF PROPELLER SHAFTS

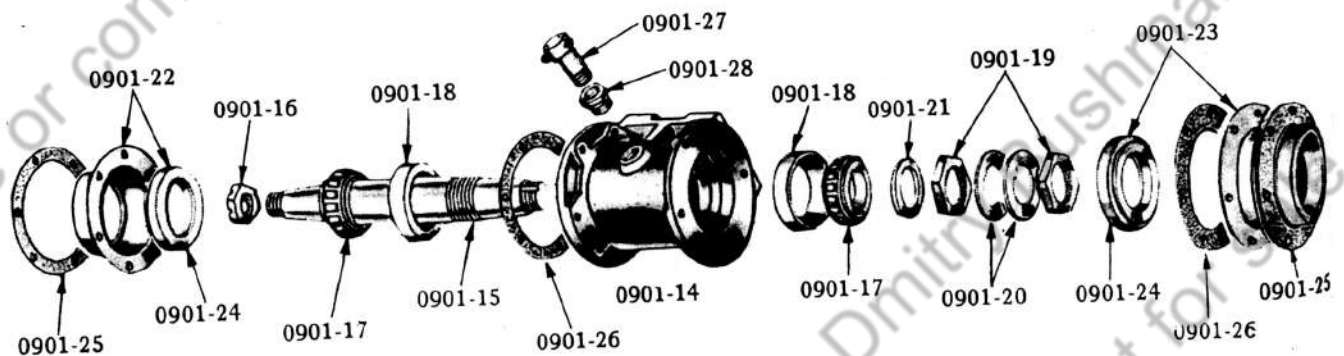

MIDSHIP SHAFT AND PILLOW BLOCK

PLATE 28

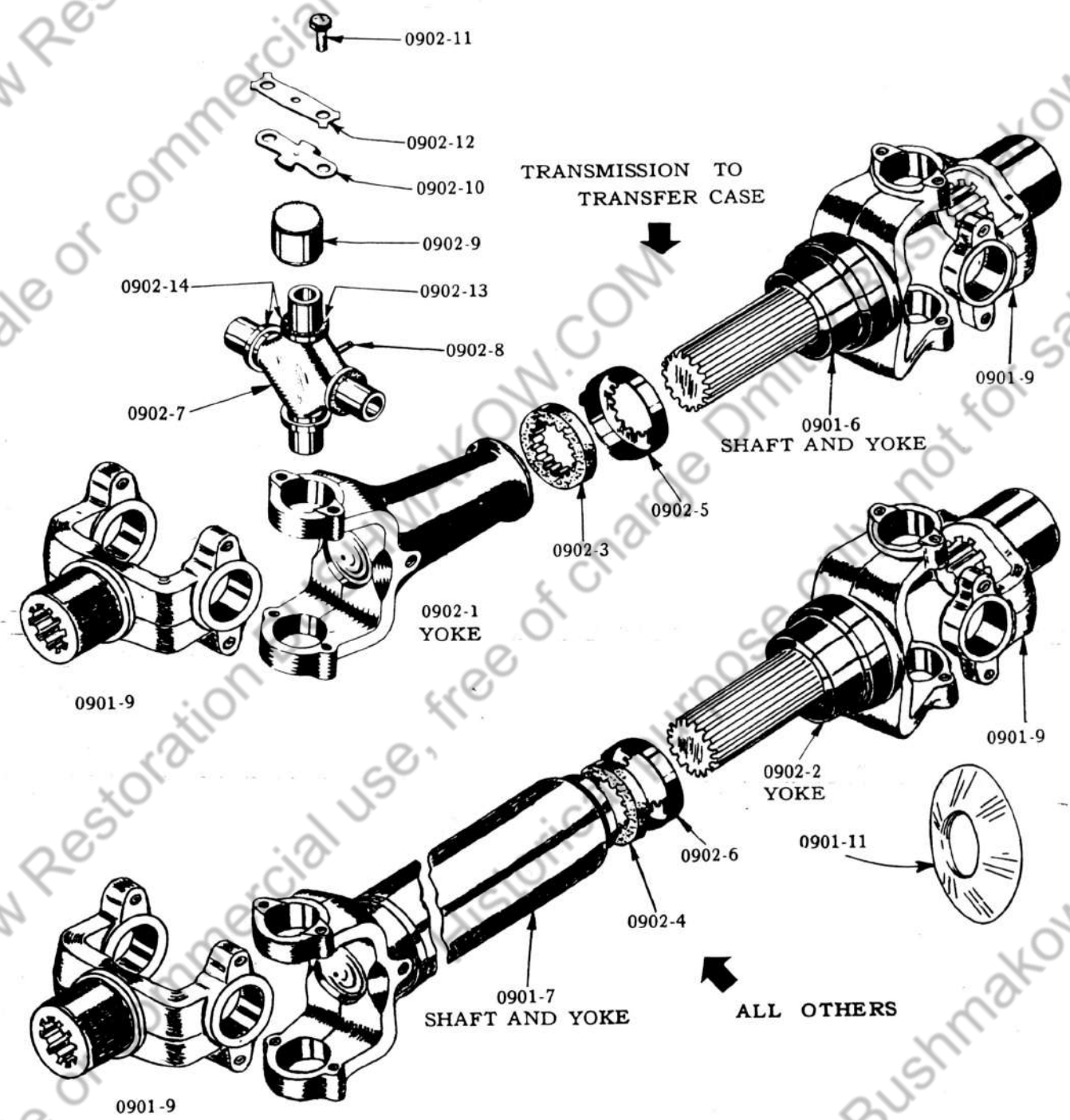

CLEVELAND TYPE

PROPELLER SHAFT AND UNIVERSAL JOINTS

PLATE 29

TRANSMISSION TO
TRANSFER CASE

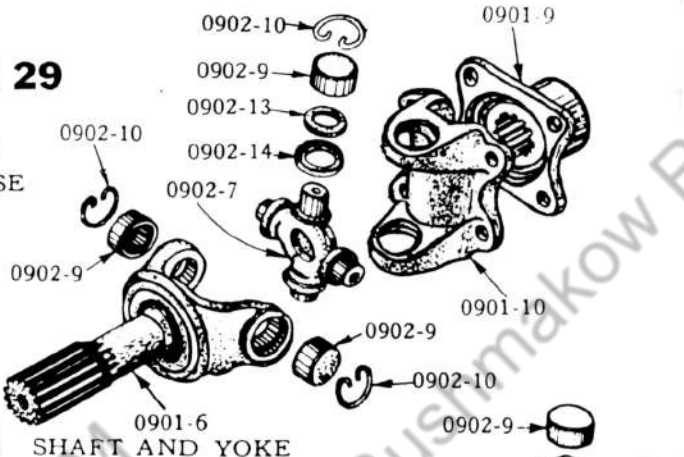

SHAFT AND YOKE

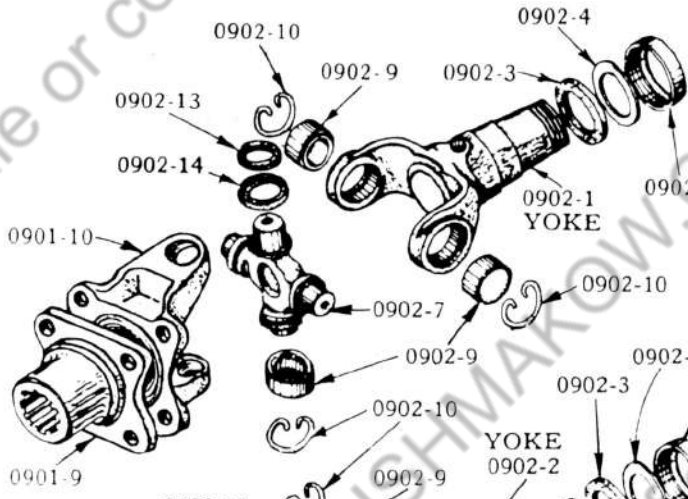

SHAFT AND YOKE

TRANSFER CASE TO
PILLOW BLOCK

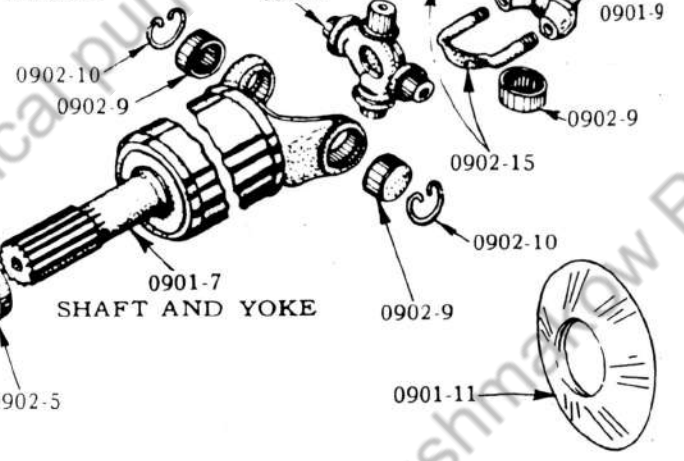

SHAFT AND YOKE

ALL OTHERS

SPICER TYPE

PROPELLER SHAFT AND UNIVERSAL JOINTS

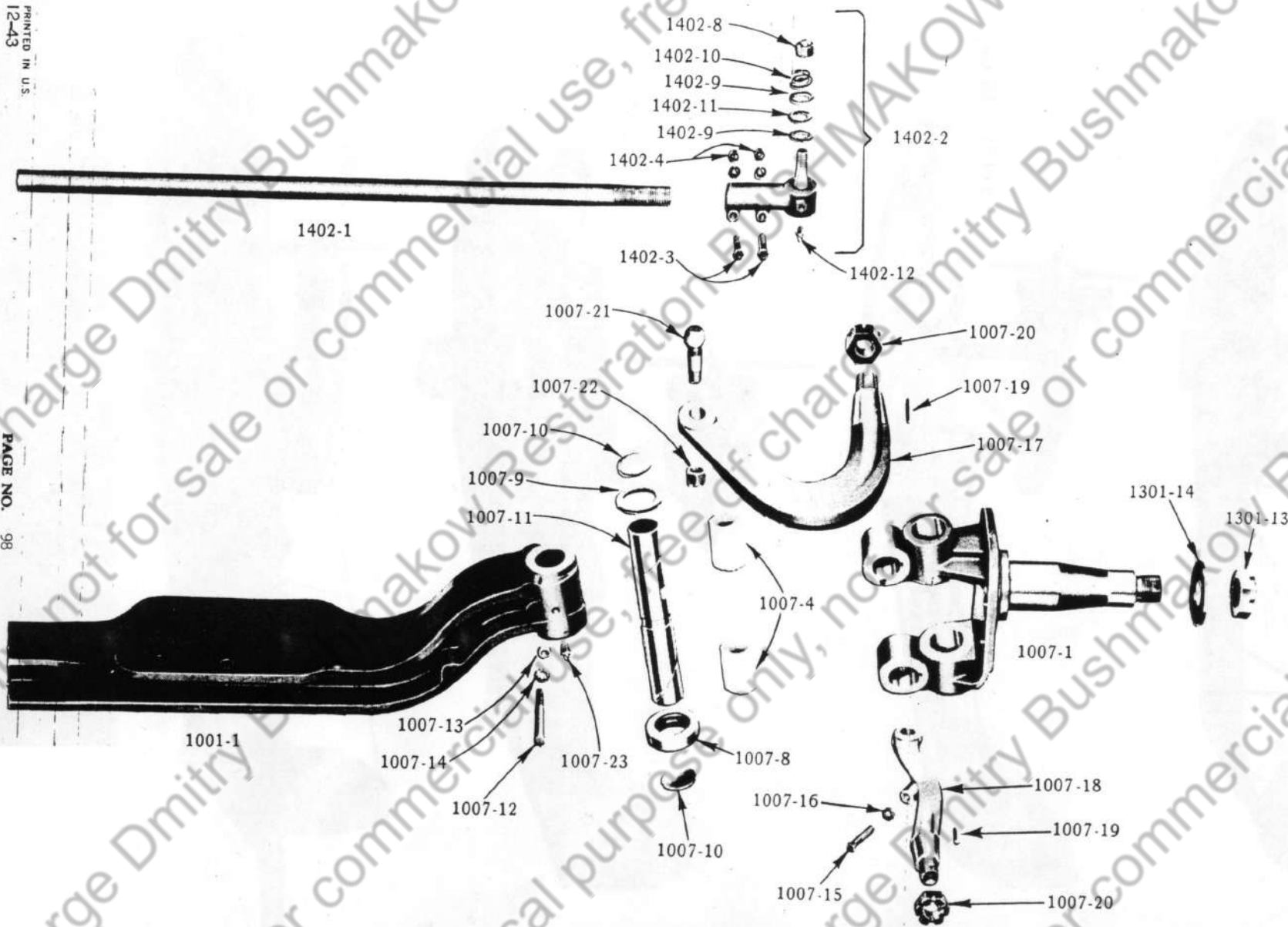

**10-FRONT AXLE
PLATE 30**

10

FRONT AXLE AND TIE ROD (FOR 6X4)

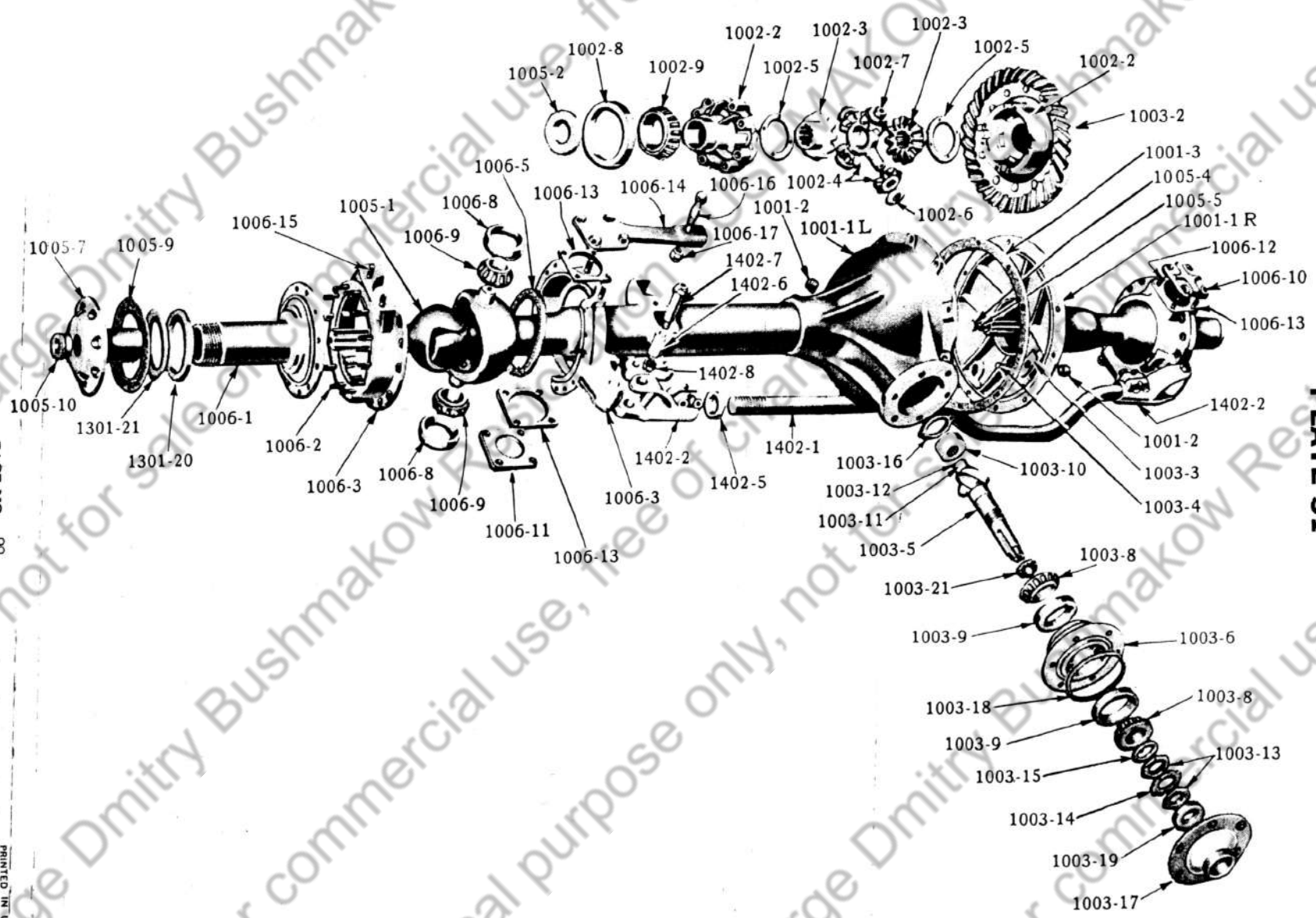
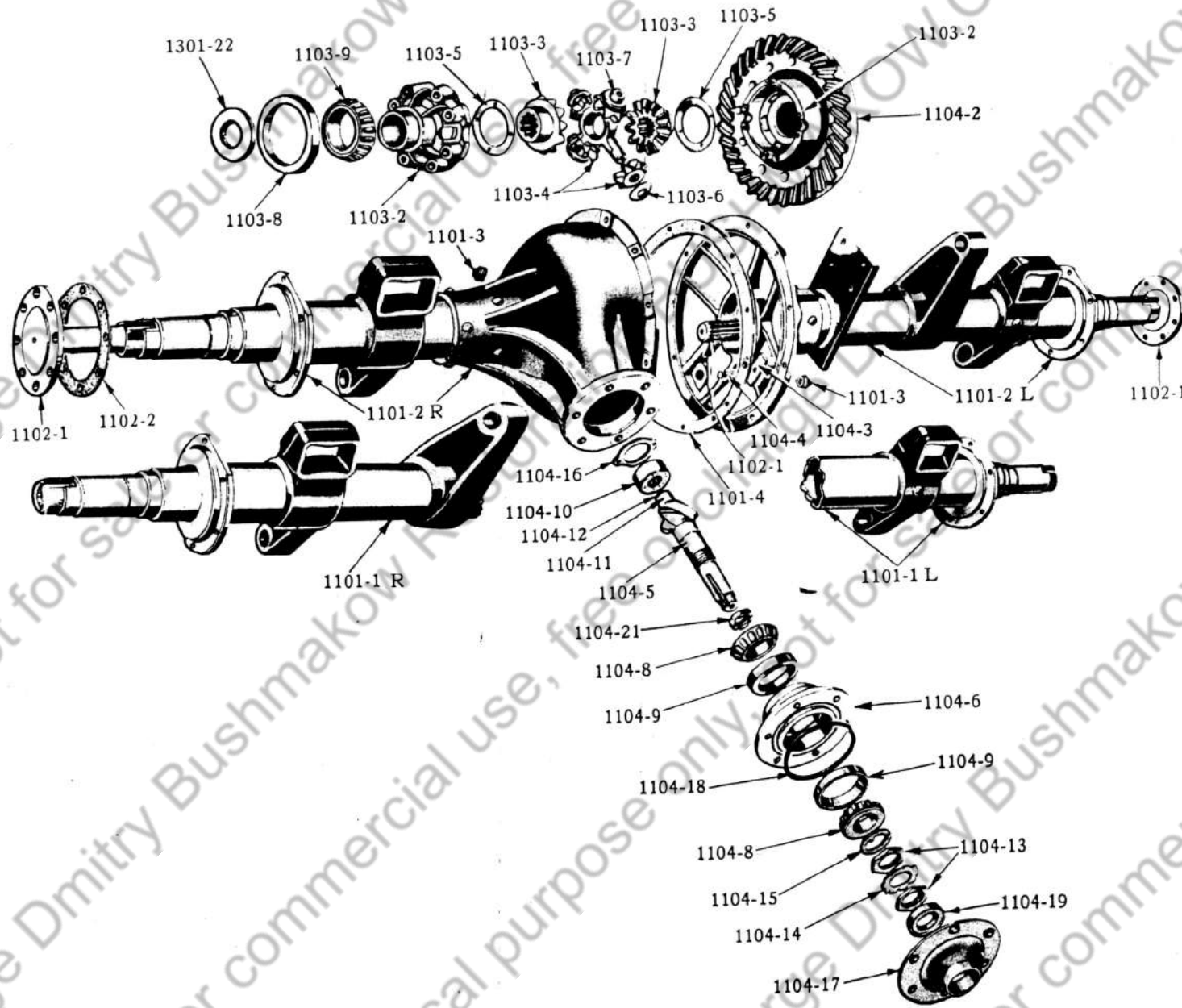

PLATE 31

FRONT AXLE, DIFFERENTIAL AND TIE ROD (FOR 6X6)

PAGE NO. 99

PRINTED IN U.S.A.
12-43



REAR AXLE AND DIFFERENTIAL

**11 - REAR AXLE
PLATE 32**

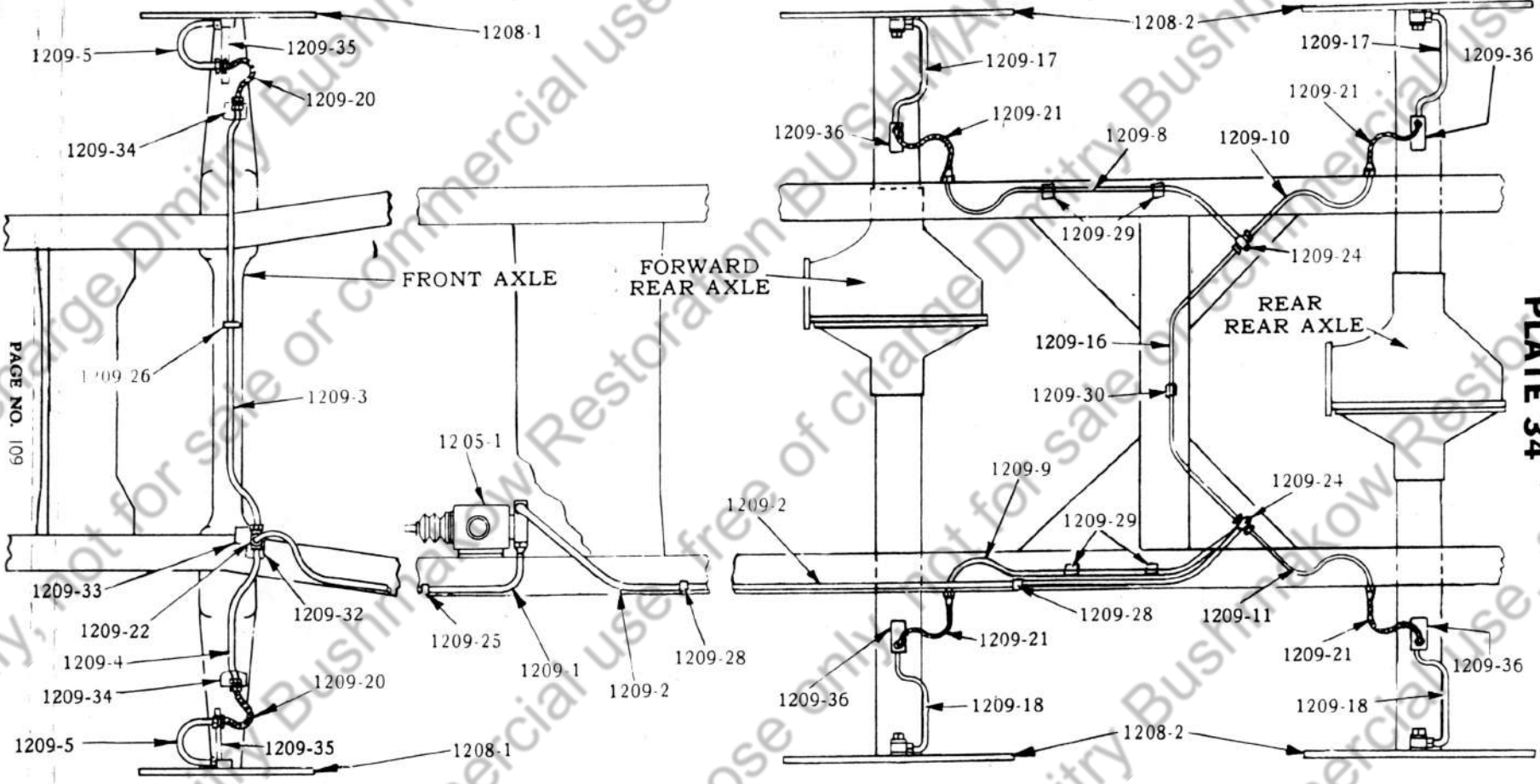

PAGE NO. 109

PLATE 34

BRAKE PIPES, HOSE, CLIPS, BRACKETS AND TEES (FOR 6X4)

PRINTED IN U.S.A.
12-43

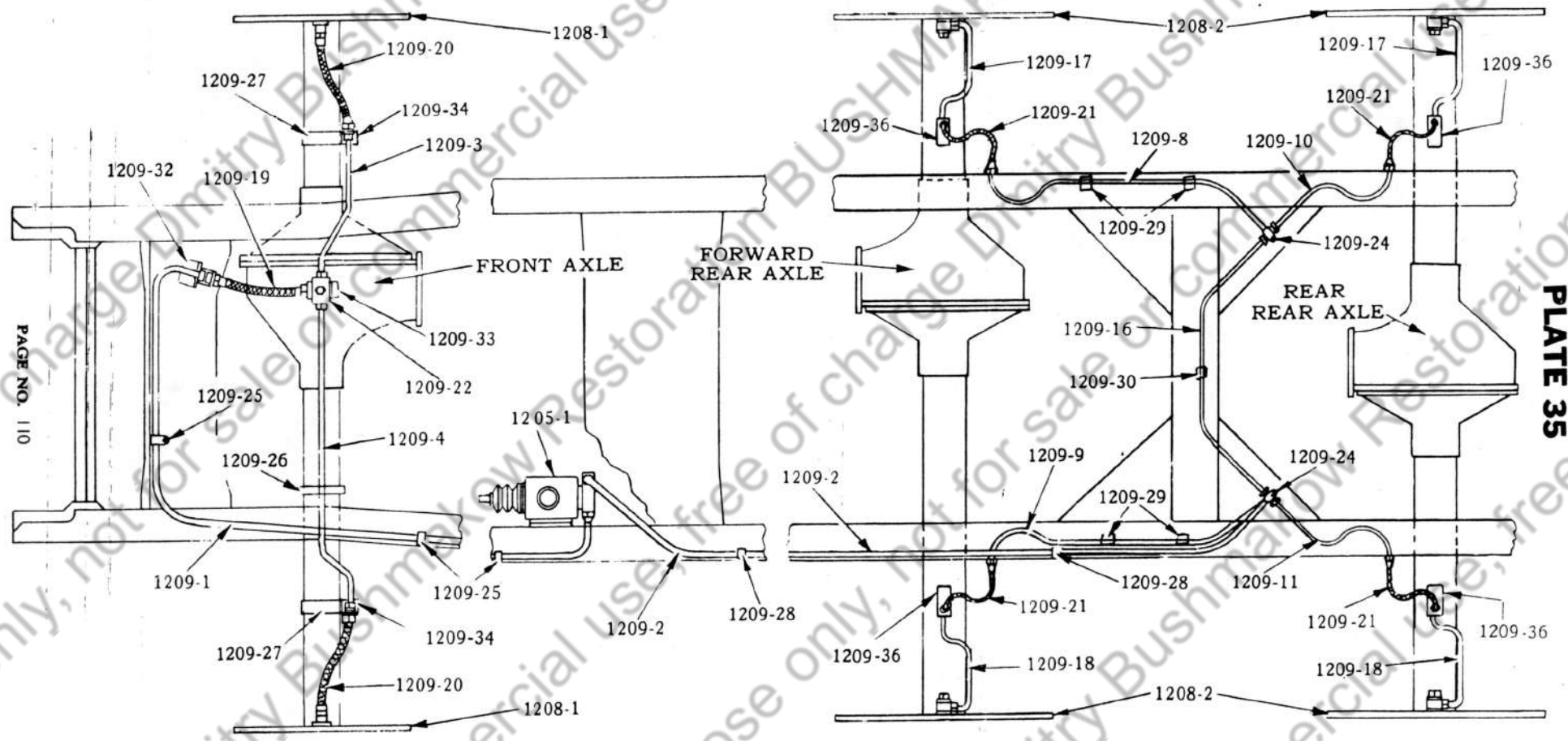

PAGE NO. 110

PLATE 35

BRAKE PIPES, HOSE, CLIPS, BRACKETS AND TEES (FOR 6X6)

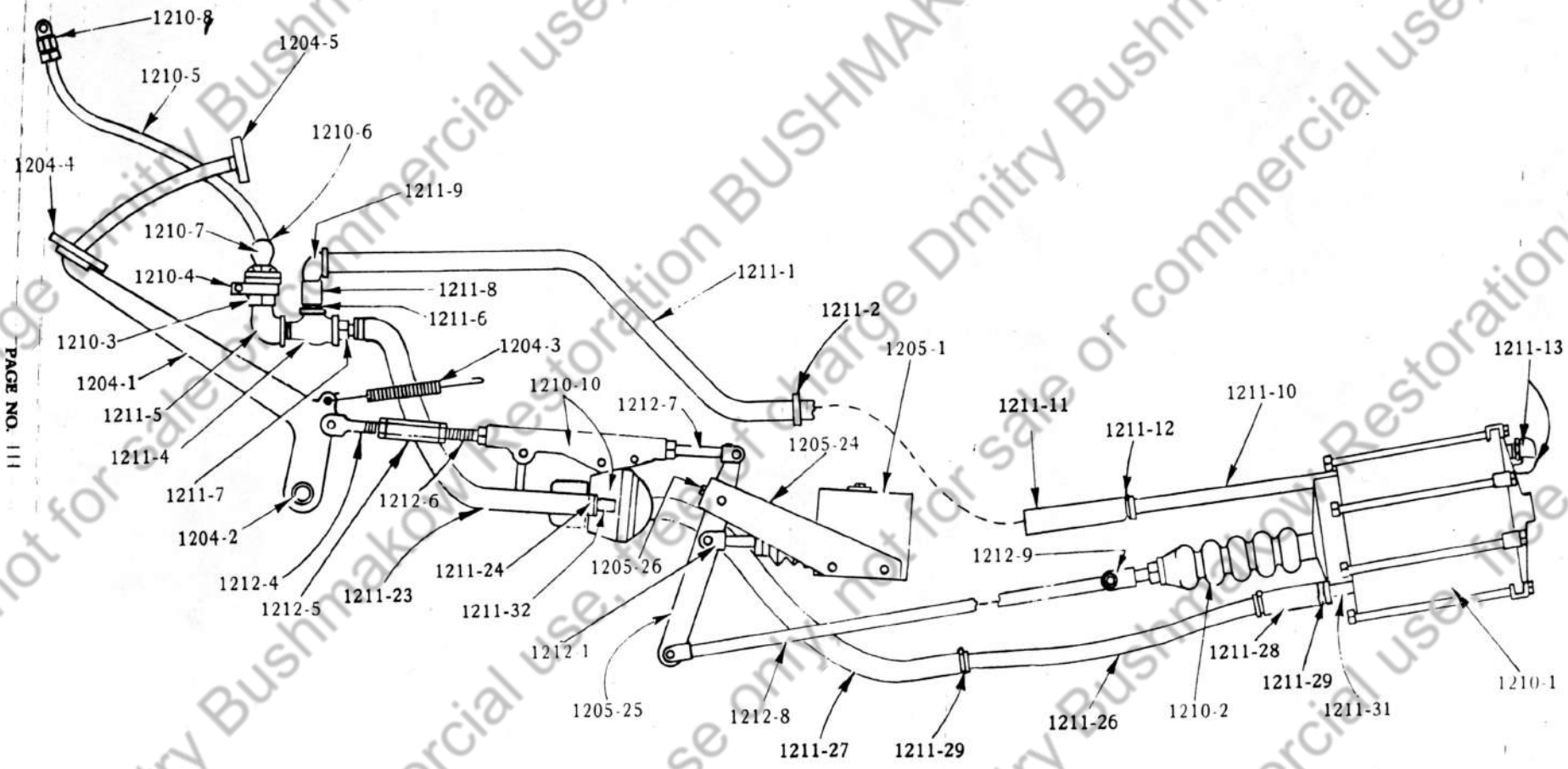

PAGE NO. 111

PRINTED IN U.S.A.
12-43

BRAKE PEDAL AND BOOSTER OPERATING MECHANISM

PLATE 36

PRINTED IN U.S.A.
12-43

TOP VIEW

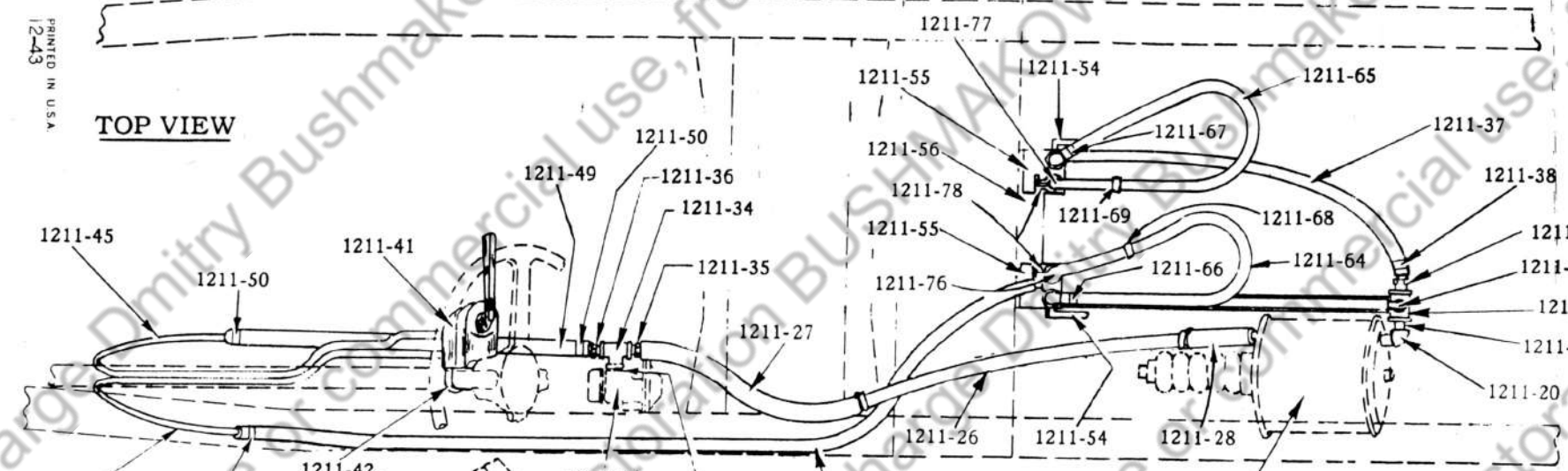

SIDE VIEW

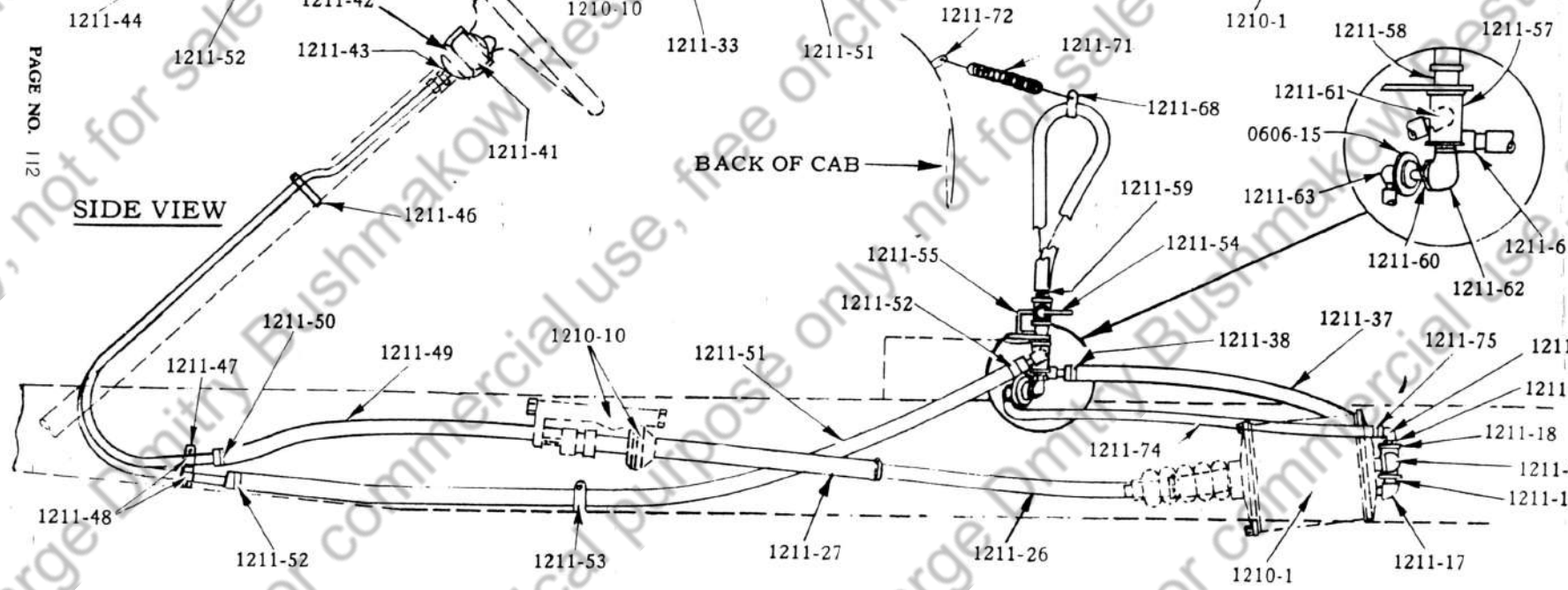

BACK OF CAB

12

PLATE 37

**ADDITIONAL PARTS FOR TRAILER CONNECTIONS
(FOR TRACTOR)**

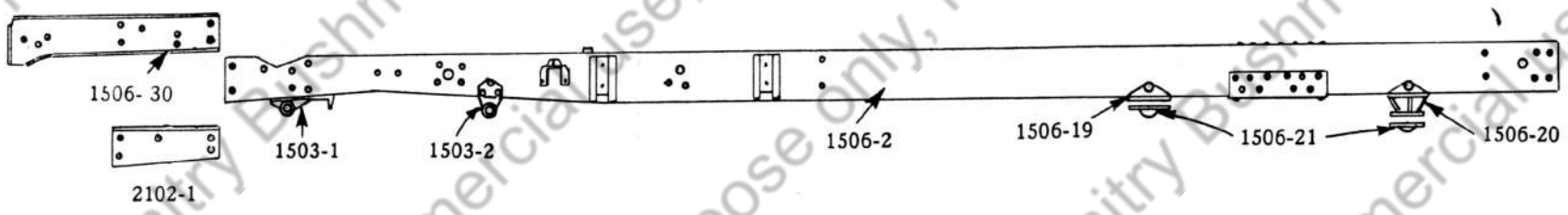
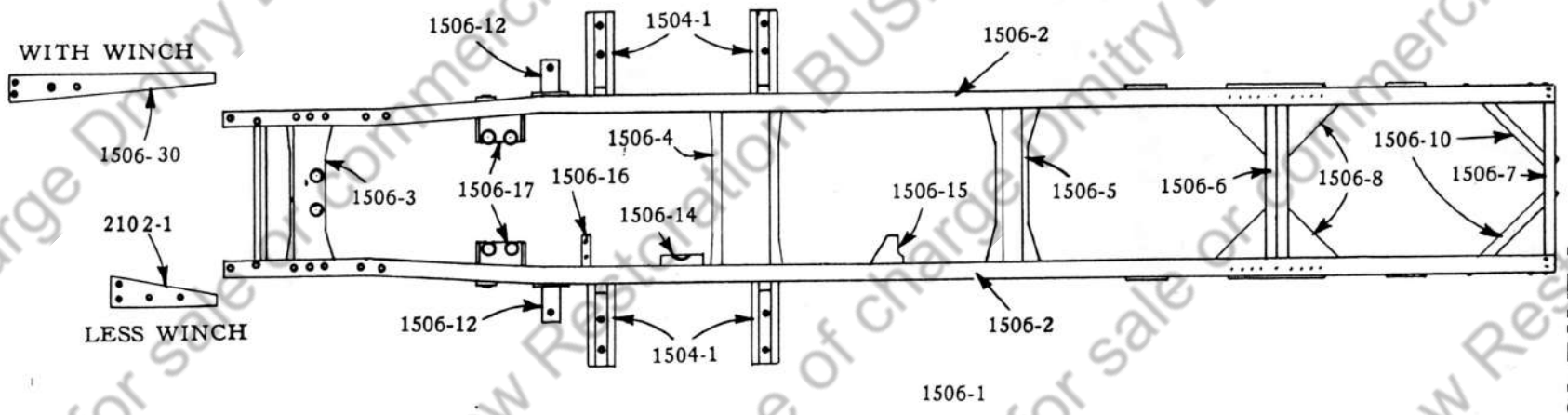

FRAME

15-FRAME AND BRACKETS
PLATE 40

PLATE 41

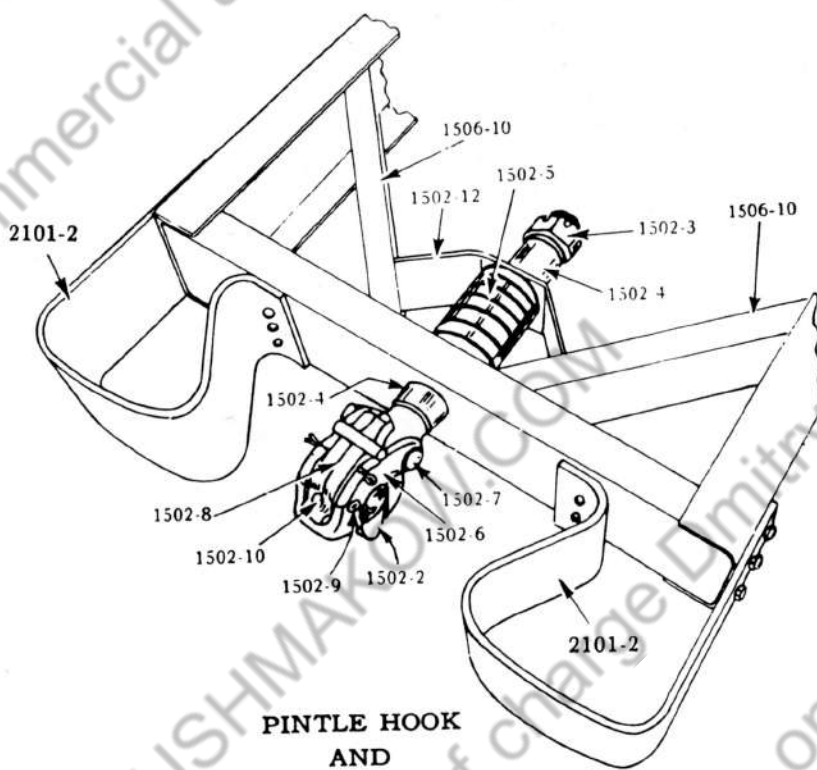

**PINTLE HOOK
AND
REAR BUMPER**

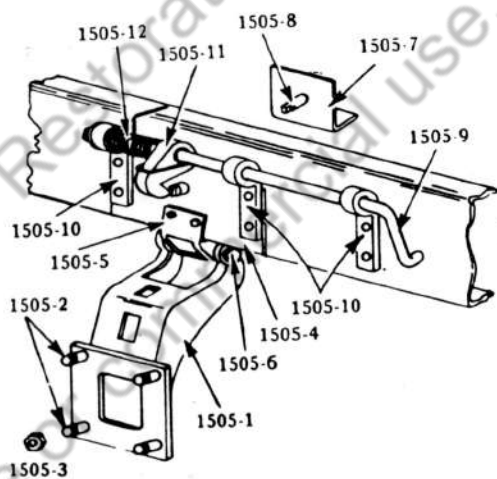

FOR 162" W.B. CARGO

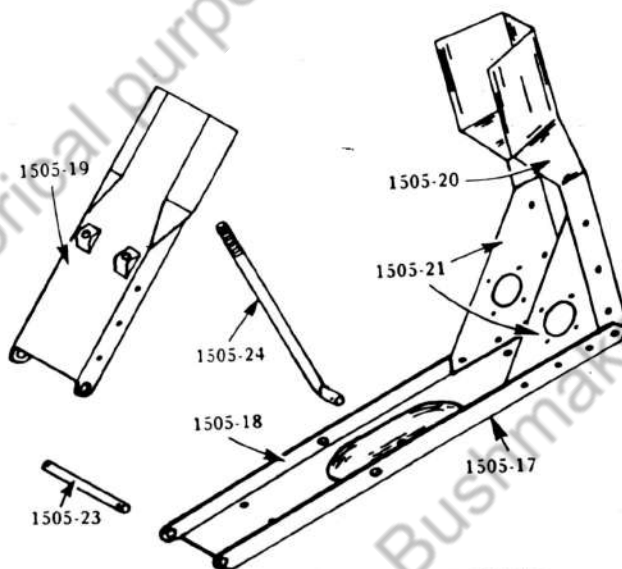

FOR TRACTOR AND DUMP

WHEEL CARRIERS

PINTLE HOOK, REAR BUMPER AND WHEEL CARRIERS

PLATE 42

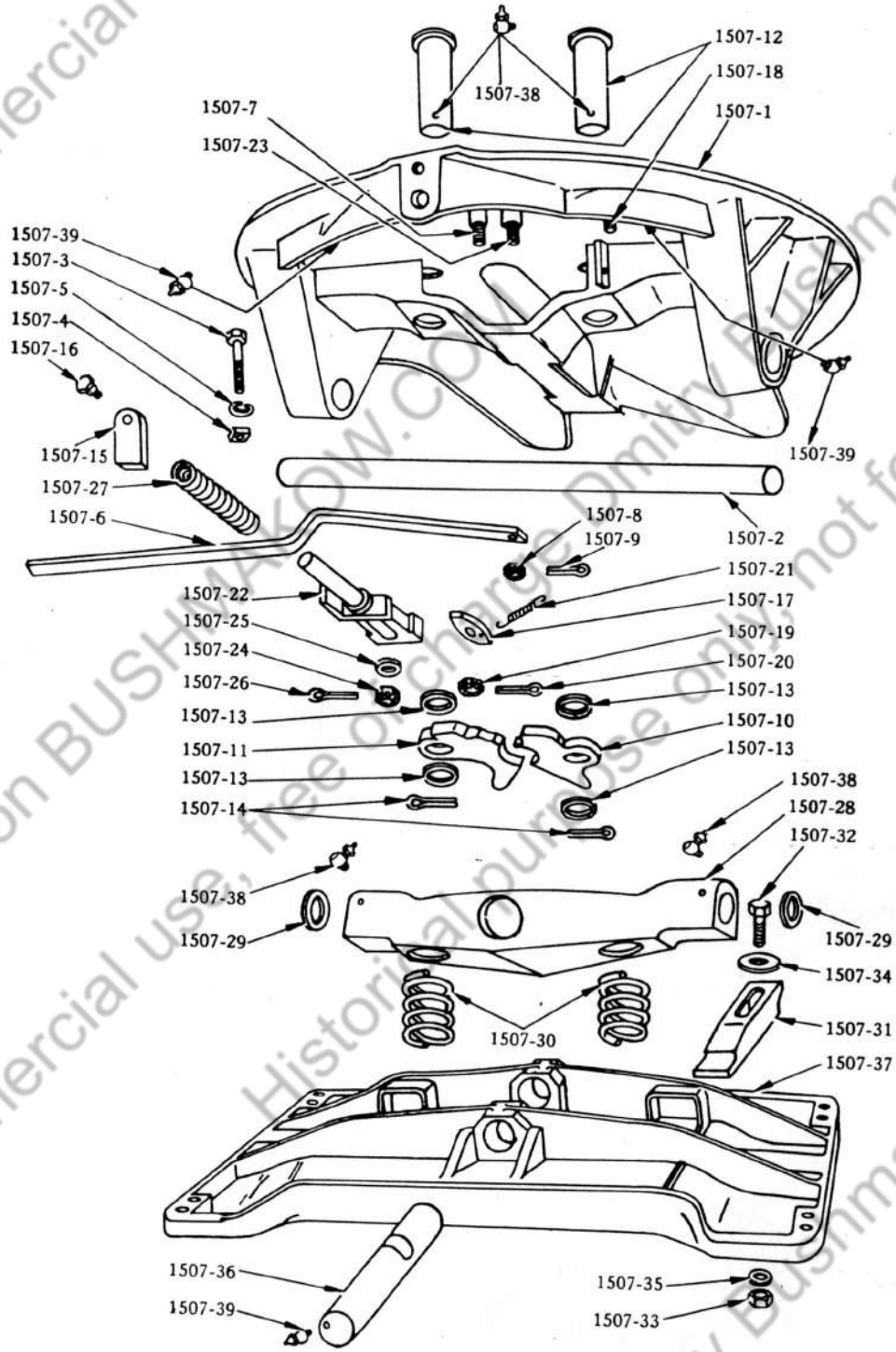

FIFTH WHEEL - TRACTOR

16- SPRINGS AND SHOCK ABSORBERS PLATE 43

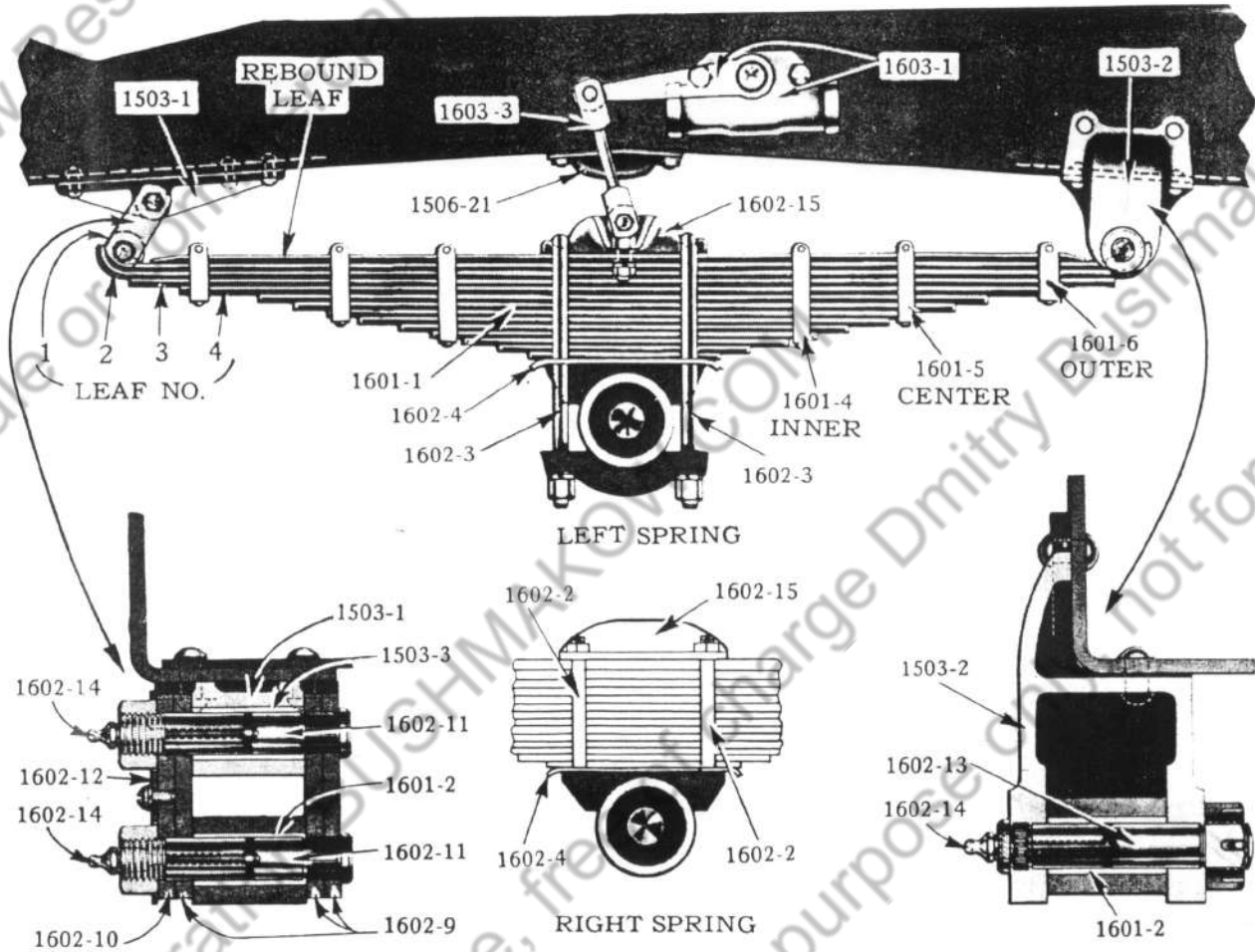

FRONT SPRING AND SHOCK ABSORBER

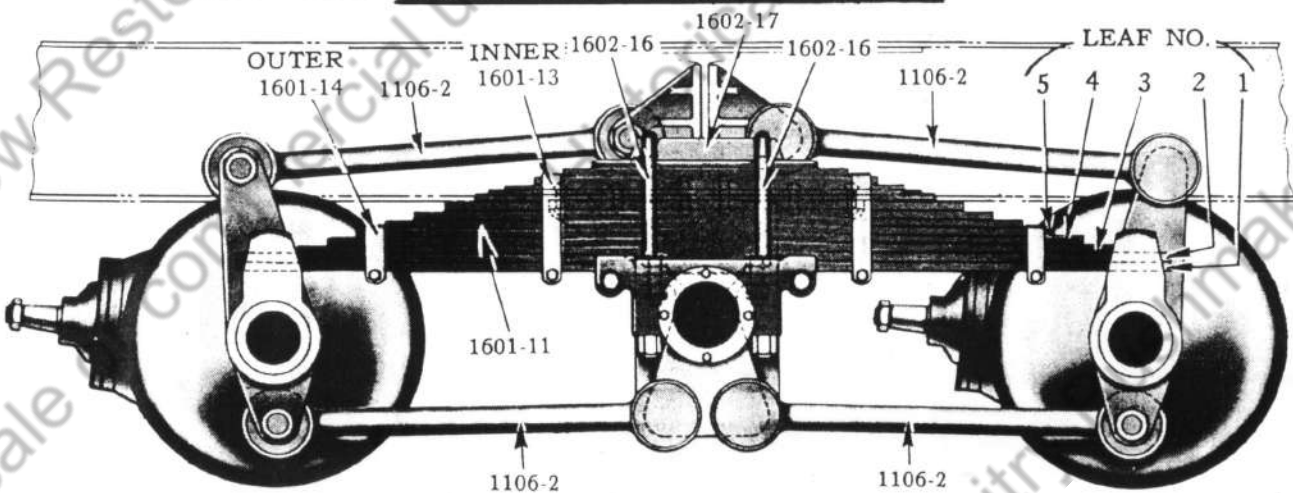

REAR SPRING AND TORQUE ARMS

FRONT AND REAR SPRINGS DETAIL

PLATE 44

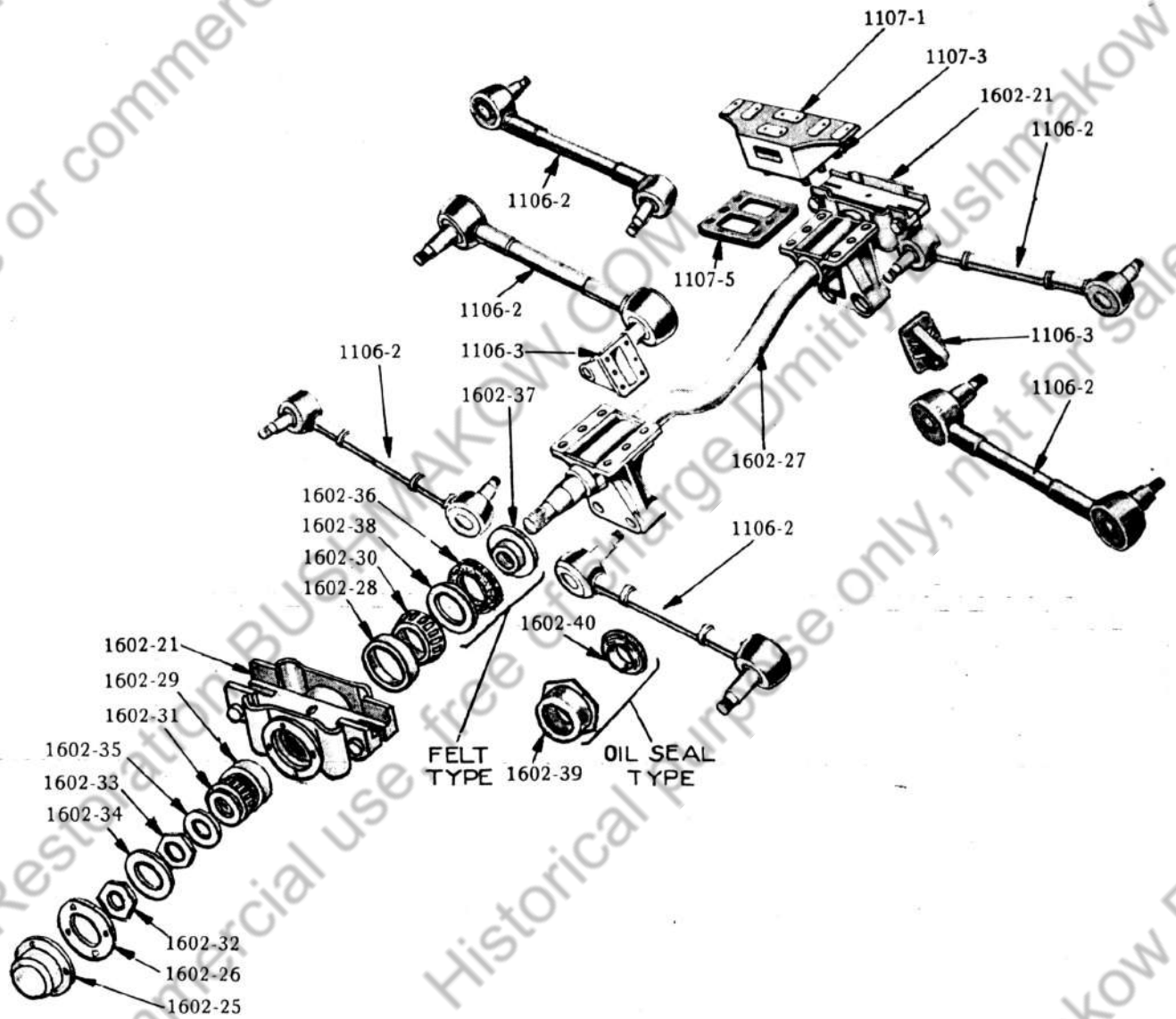

REAR SPRING MOUNTING DETAIL

17- HOOD, FENDERS, RUNNING BOARDS, APRONS (MISC. SHEET METAL)

PLATE 45

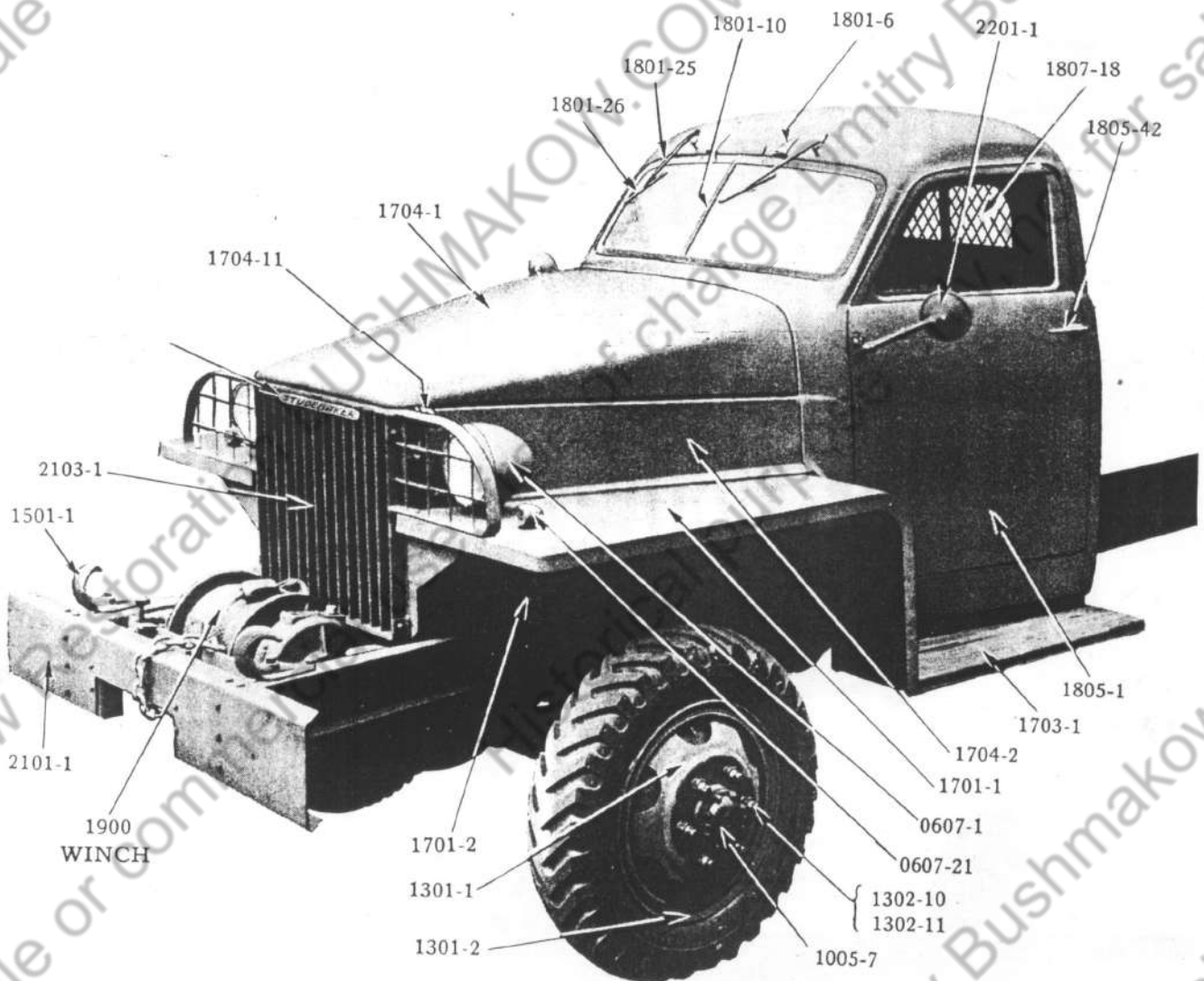

FRONT END (STEEL TOP CAB)

PLATE 46

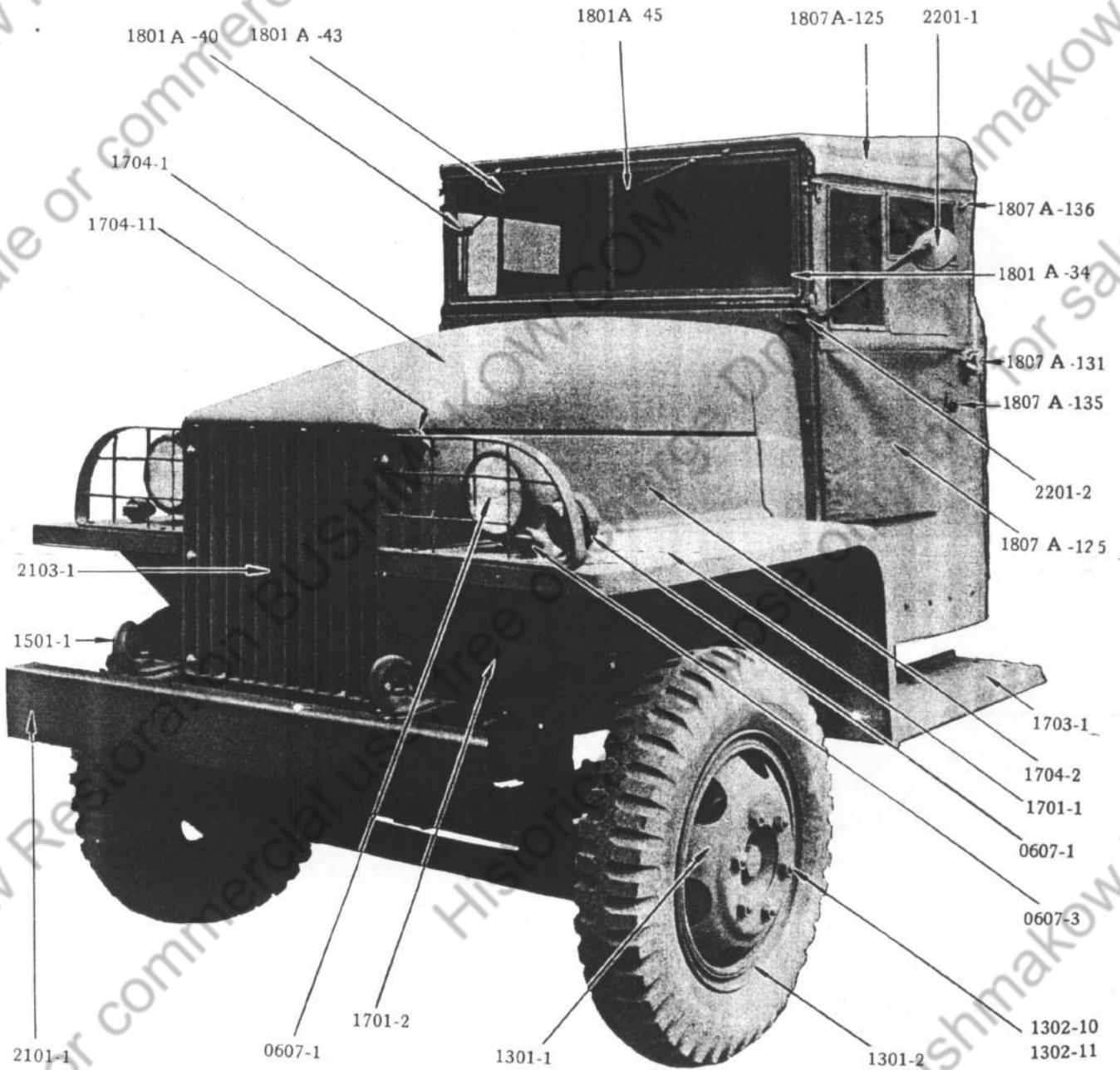

FRONT END (SOFT TOP CAB)

**18- BODY
PLATE 47**

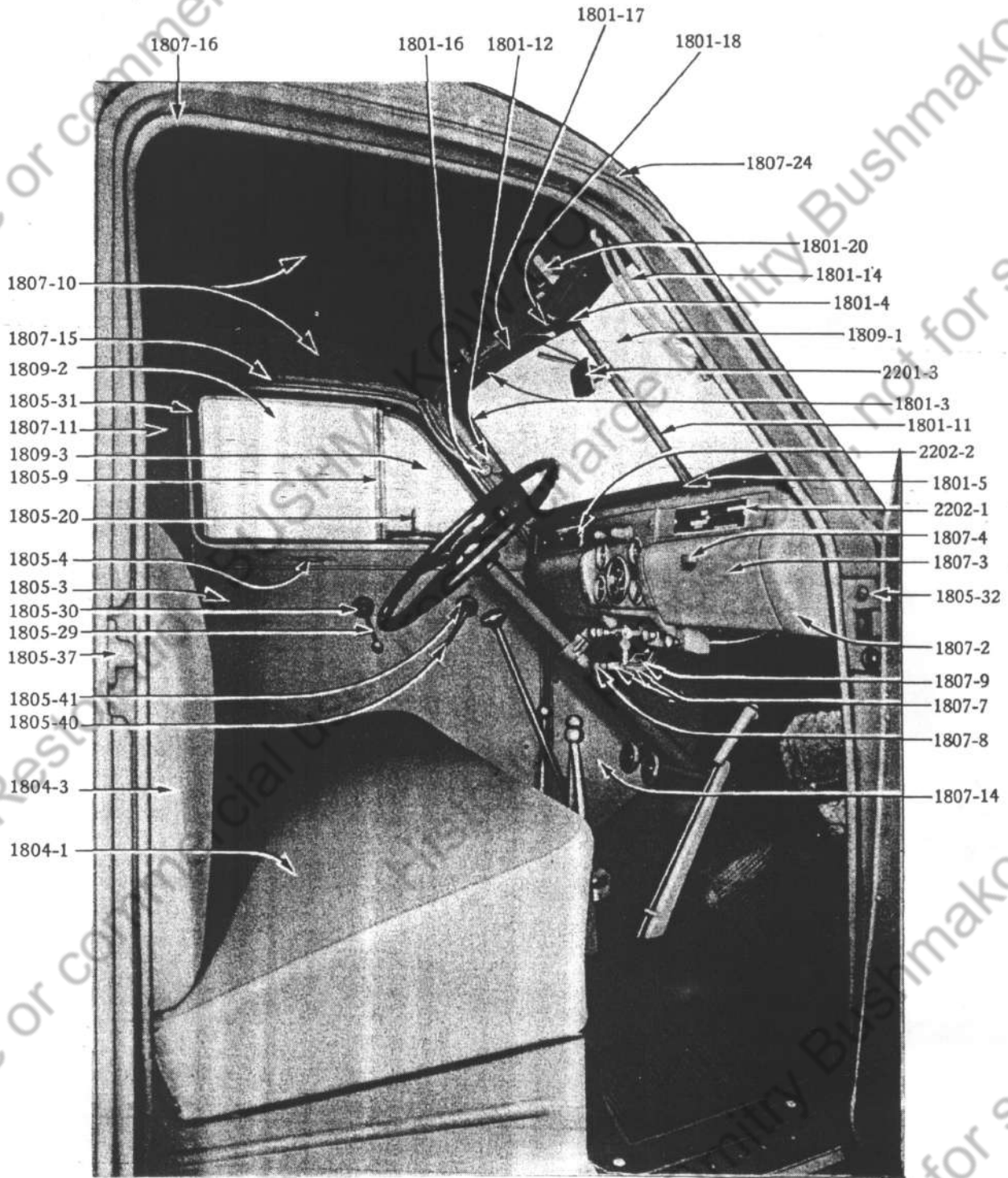

CAB INTERIOR (STEEL TOP CAB)

PLATE 48

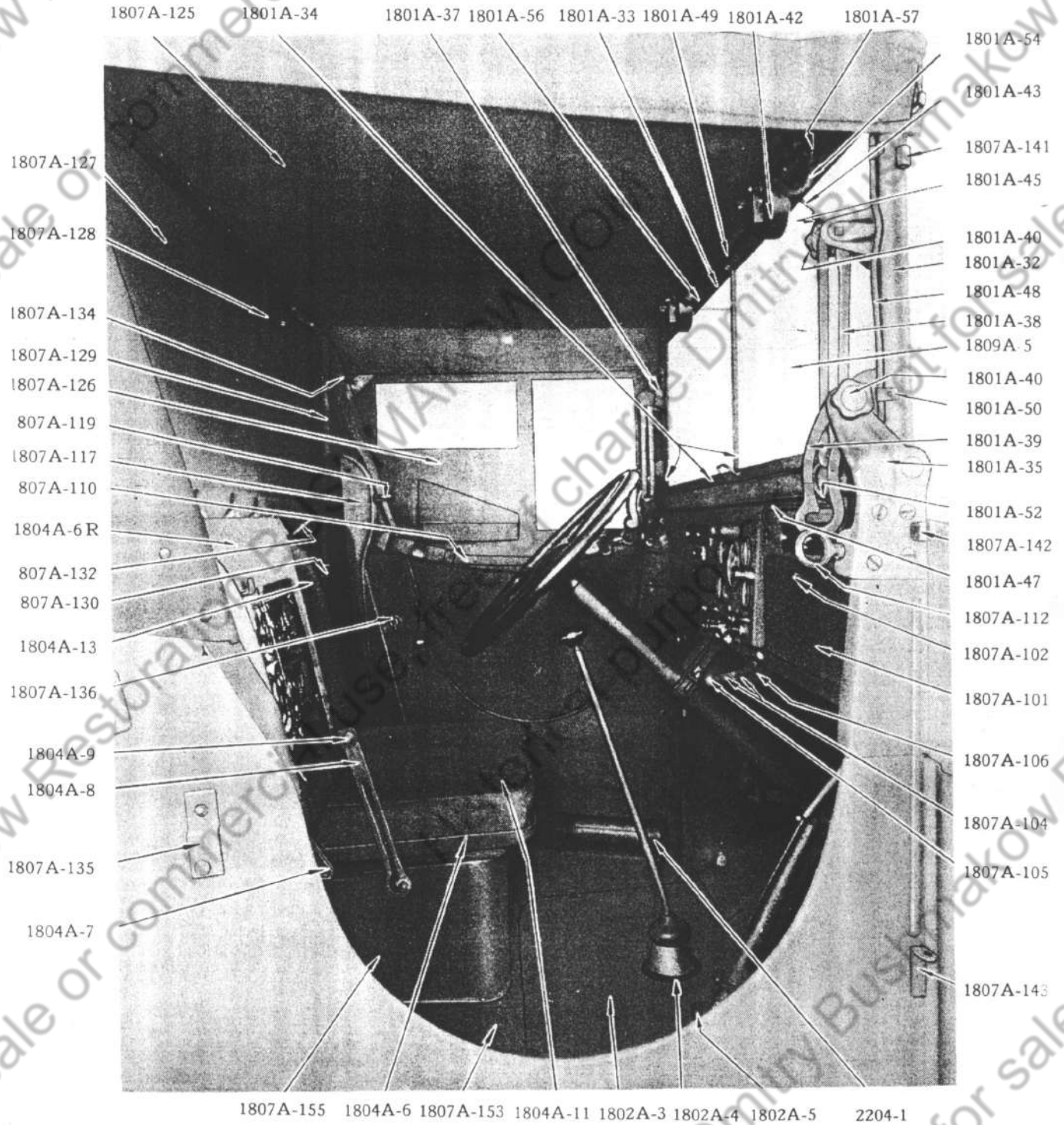

CAB INTERIOR (SOFT TOP CAB)

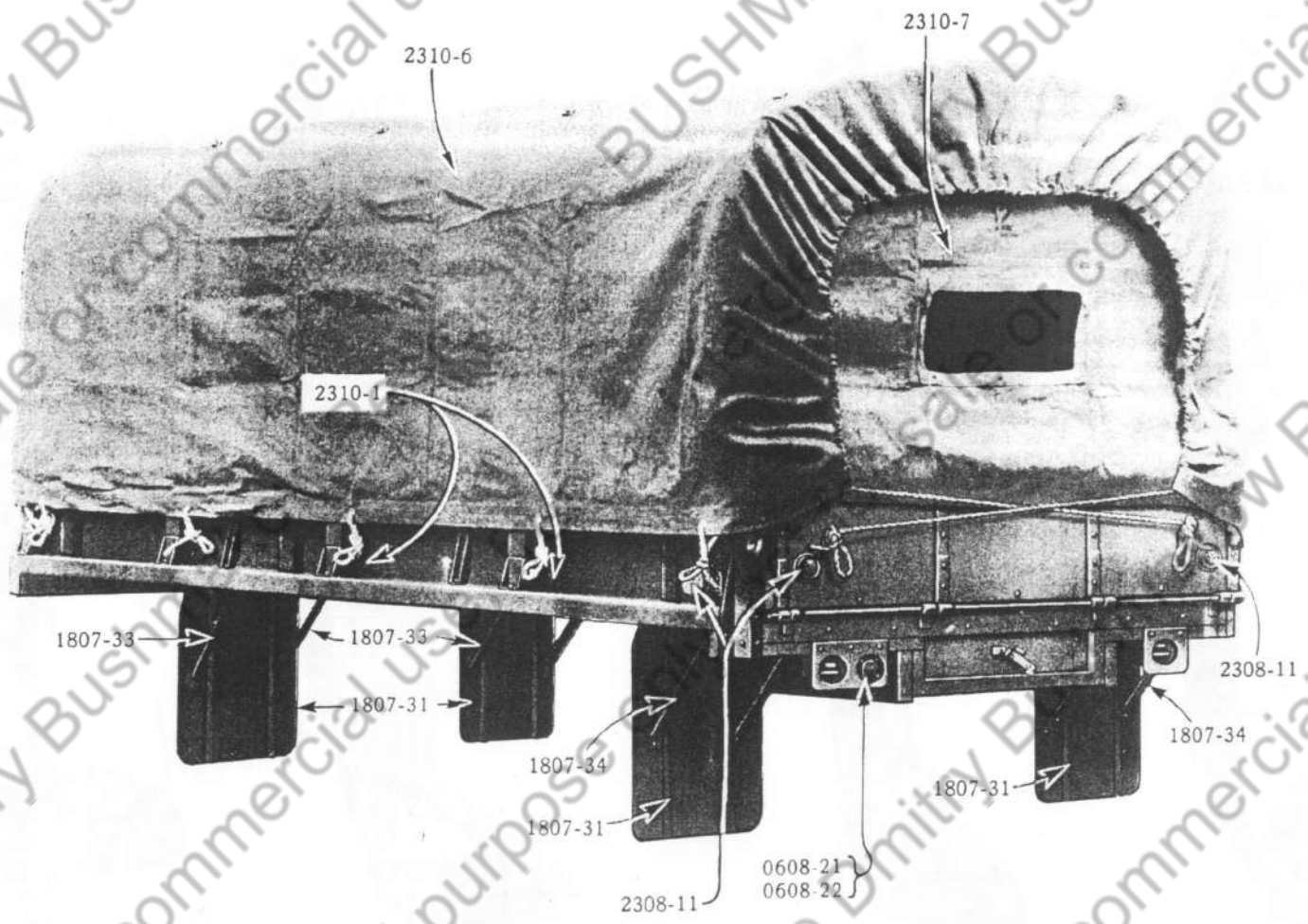

CARGO BODY TARPULIN AND SPLASHGUARD DETAIL

PLATE 50

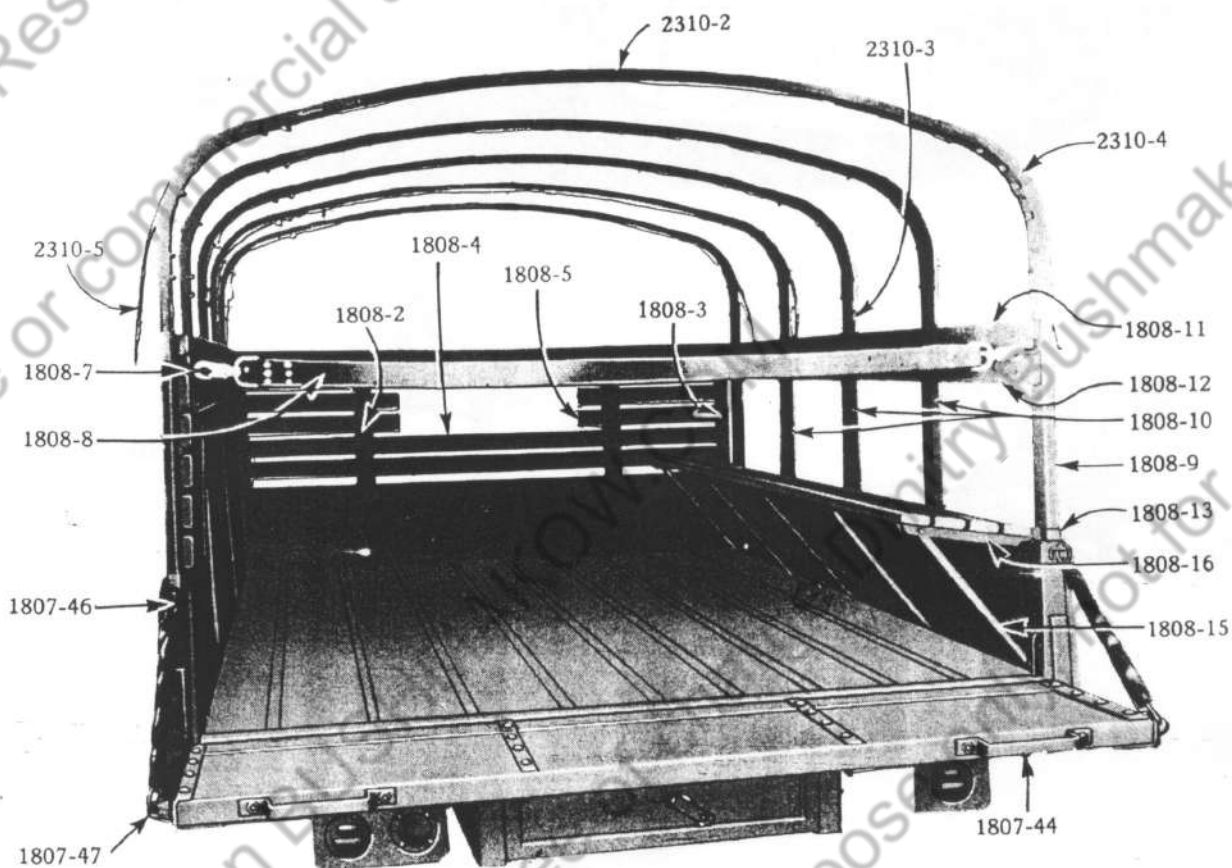

CARGO BODY DETAIL

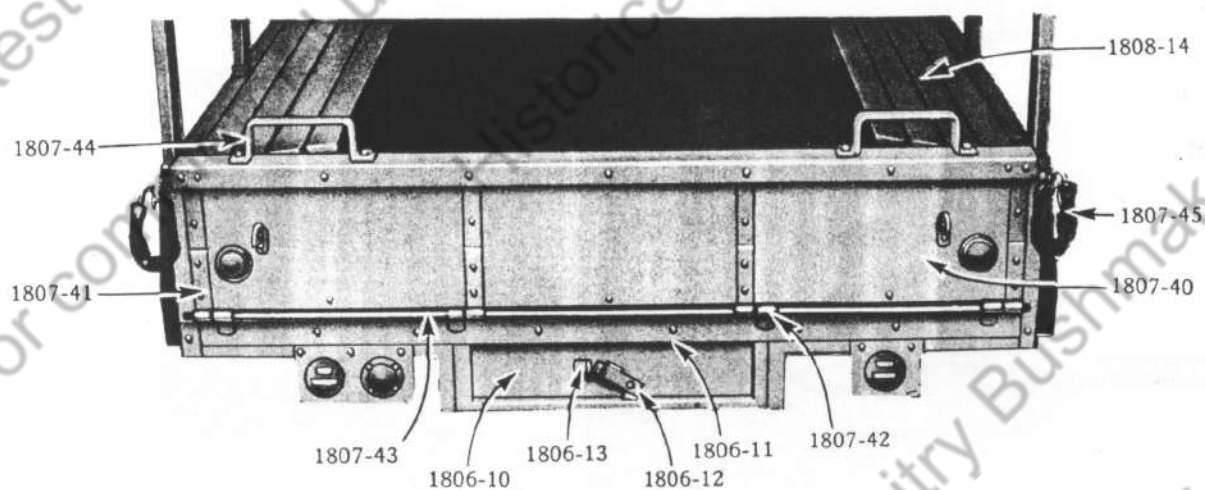

TAIL GATE DETAIL

20- HOIST, PUMP AND POWER TAKE-OFF PLATE 53

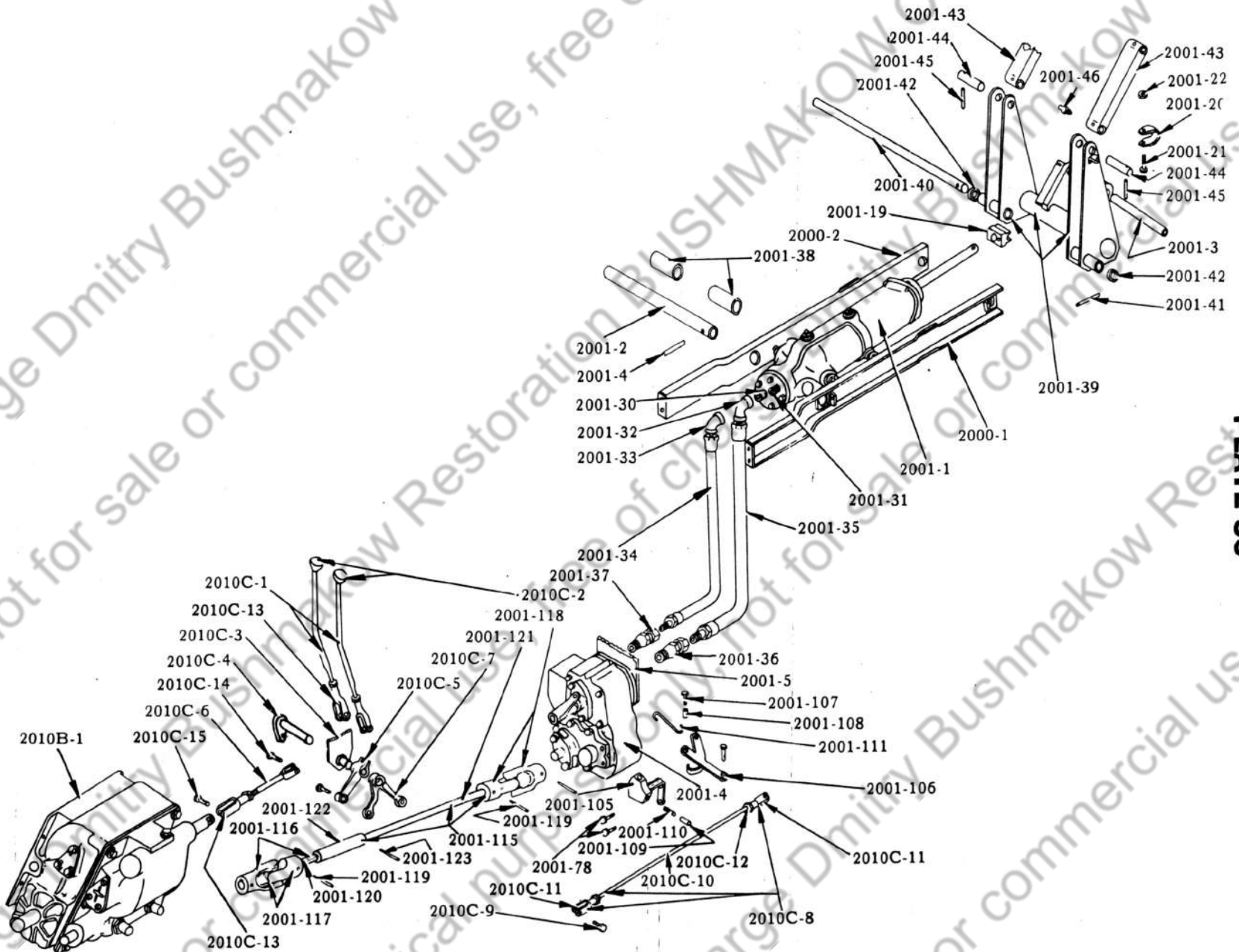

REAR DUMP HOIST CONTROL

PAGE NO. 185

PRINTED IN U.S.A.
12-43

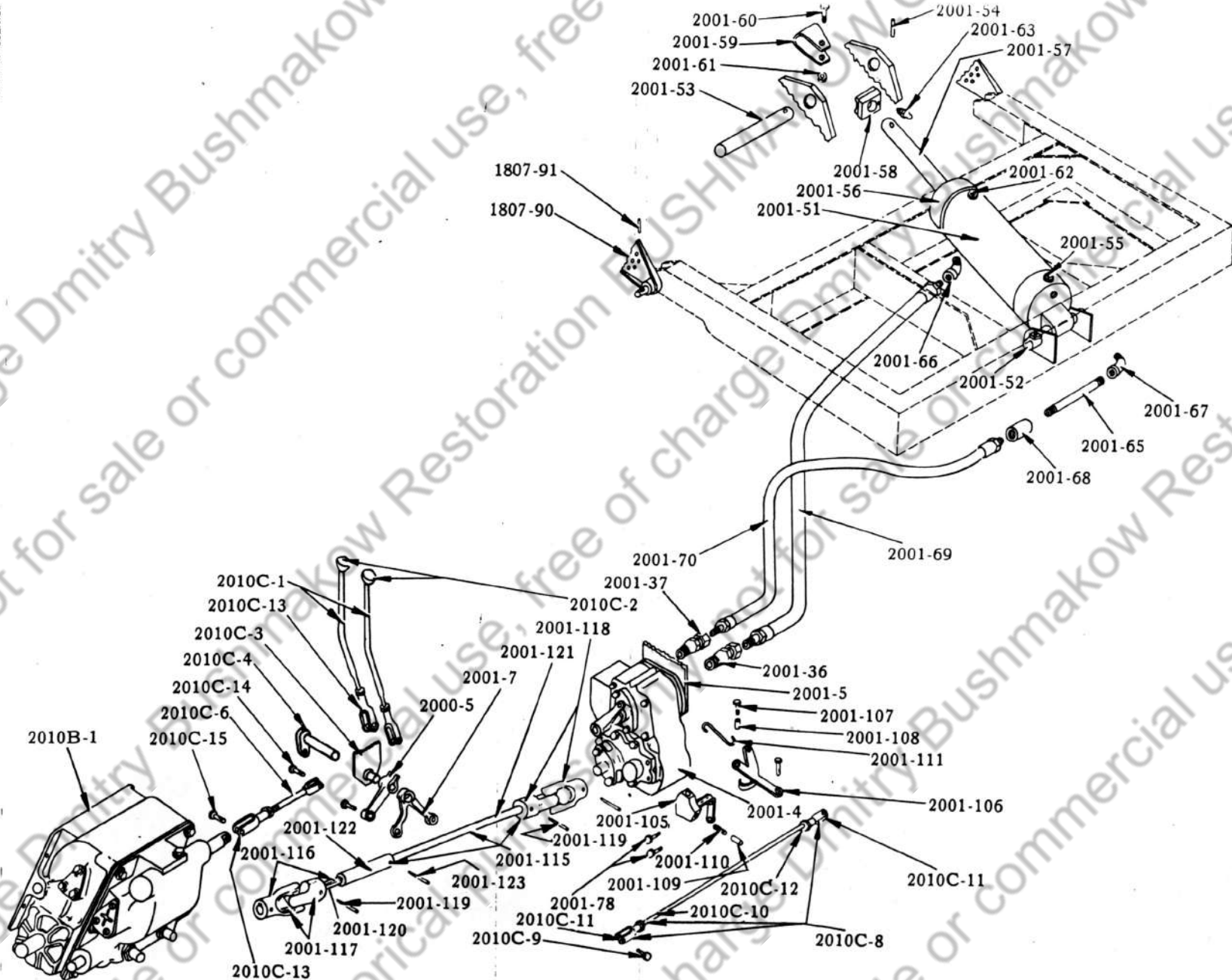

SIDE DUMP HOIST CONTROL

ILLUST. NUMBER	PART NUMBER		DESCRIPTION	PER CAR
	MANUFACTURER	STUDEBAKER		
	MOTO-METER			
0304-10	9826-A	666875	GASOLINE GAUGE, TANK UNIT (FOR CARGO)	1
0304-10	10116-A	669406	GASOLINE GAUGE, TANK UNIT (FOR DUMP AND TRACTOR)	1
		55X23	SCREW, FASTENING No. 10-24X3/4"	5
		24X52	NUT, TERMINAL - HEX. No. 10-32	1
		187763	WASHER, SPECIAL (FOR 55X23) No. 10	5
		40X371	WASHER, LOCK (FOR 24X52) No. 10	1
		664817	GASKET, GASOLINE GAUGE (TANK UNIT) (FOR CARGO, DUMP AND TRACTOR)	1

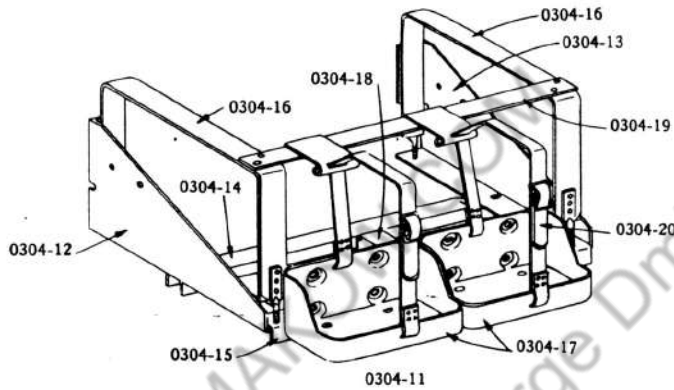

GASOLINE TANK SUPPORT

0304-11	666579	* SUPPORT ASSY., GASOLINE TANK - LESS CAN CARRIERS (FOR CARGO) - NOTE 3	1
0304-11	669413	* SUPPORT ASSY., GASOLINE TANK - LESS CAN CARRIERS (FOR TRACTOR) - NOTE 3	1
		* - THESE ASSEMBLIES CONSISTS OF THE FOLLOWING ITEMS INDICATED WITH A *.	
0304-11	672430	▼ - SUPPORT ASSY., GASOLINE TANK - WITH CARRIERS FOR TWO 5 GAL. CANS (FOR CARGO) - NOTE 4	1
0304-11	672456	▼ - SUPPORT ASSY., GASOLINE TANK - WITH CARRIERS FOR TWO 5 GAL. CANS (FOR DUMP AND TRACTOR) - NOTE 4	1
		▼ - THESE ASSEMBLIES CONSISTS OF THE FOLLOWING ITEMS INDICATED WITH A ▼.	
0304-12	664836	⚡ BRACKET, GASOLINE TANK SUPPORT FRONT (FOR CARGO)	1
0304-13	664837	⚡ BRACKET, GASOLINE TANK SUPPORT REAR (FOR CARGO)	1
0304-12	669187	⚡ BRACKET, GASOLINE TANK SUPPORT FRONT (FOR DUMP AND TRACTOR)	1
0304-13	669188	⚡ BRACKET, GASOLINE TANK SUPPORT REAR (FOR DUMP AND TRACTOR)	1
	11X61	BOLT, TO FRAME 3/8"-24X1 5/8"	8
	21X3	NUT, HEX. 3/8"-24	8
	40X433	WASHER, LOCK 3/8"	8
0304-15	666578	* TIE BAR, GASOLINE TANK SUPPORT OUTER (FOR CARGO) - NOTE 3 - USE 672418 WHEN STOCK IS EXHAUSTED.	1
0304-15	672418	▼ TIE BAR, GASOLINE TANK SUPPORT OUTER (FOR CARGO) - NOTE 4	1
0304-14	667061	⚡ TIE BAR, GASOLINE TANK SUPPORT INNER (FOR CARGO)	1
0304-15	669415	* TIE BAR, GASOLINE TANK SUPPORT OUTER (FOR TRACTOR) - NOTE 3 - USE 672453 WHEN STOCK IS EXHAUSTED.	1
0304-15	672453	▼ TIE BAR, GASOLINE TANK SUPPORT OUTER (FOR DUMP AND TRACTOR) - NOTE 4	1
0304-14	669414	⚡ TIE BAR, GASOLINE TANK SUPPORT INNER (FOR DUMP AND TRACTOR)	1
	11X24	BOLT, OUTER BAR 3/8"-24X1"	4
	57X215	BOLT, INNER BAR 3/8"-24X1"	2
	21X3	NUT, HEX. 3/8"-24	6
	40X433	WASHER, LOCK 3/8"	6
0304-16	667579	▼ STRAP, GASOLINE TANK (WITH ENDS AND LINERS) (FOR CARGO)	2
0304-16	669417	▼ STRAP, GASOLINE TANK (WITH ENDS AND LINERS) (FOR DUMP AND TRACTOR)	2
	21X164	NUT, HEX. 7/16"-20	8

NOTES { 3 - USED BEFORE CAR SERIAL MODEL US6 MODEL US6x4
US6-37912 US6x4-29151
4 - USED ON AND AFTER CAR SERIALS IN NOTE 3.

RADIO INTERFERENCE SUPPRESSION

FILTERS, CONDENSERS, SUPPRESSORS AND WIRING

GROUP AND ILLUSTR. No.	LEGEND	GROUP AND ILLUSTR. No.	LEGEND
0601-1	GENERATOR	0604-11	SPARK PLUG CABLES (WITH SUPPRESSOR)
0601-2	GENERATOR CONDENSER	0604-12	DISTRIBUTOR SUPPRESSOR (ON CABLE)
0601-41	VOLTAGE AND CURRENT REGULATOR	0604-13	SPARK PLUG SUPPRESSOR (ON CABLE)
0603-1	DISTRIBUTOR	0606-17	VOLTAGE REGULATOR TO GENERATOR AND LARGE FILTER WIRING HARNESS
0604-1	IGNITION COIL	0606-22	LARGE FILTER TO VOLTAGE REGULATOR "B" TERMINAL CABLE
0604-2	IGNITION COIL CONDENSER	0606-23	LARGE FILTER TO STARTER SWITCH CABLE
0604-3	IGNITION COIL SUPPORT	0612-1	FILTER (LARGE) LOCATED ON DASH
0604-9	IGNITION COIL TO DISTRIBUTOR LOW TENSION CABLE	0612-2	FILTER (SMALL) LOCATED ON VOLTAGE REGULATOR
0604-10	IGNITION COIL TO DISTRIBUTOR HIGH TENSION CABLE (WITH SUPPRESSOR)		

ILLUST. NUMBER	PART NUMBER		DESCRIPTION	PER CAR
	MANUFACTURER	STUDEBAKER		

AUTO LITE
KIT 9 S-514

REPAIR KIT, GENERATOR - USE S-555 WHEN STOCK IS EXHAUSTED .
S-514 KIT CONSISTS OF:

Auto LITE	STUDE.	DESCRIPTION
1-X-260	3X9	PULLEY KEY
1-X-156		PULLEY NUT
1-8X-715	55X132	COMMUTATOR SHIELD BOLT
1-8X-794	27X14	COMMUTATOR SHIELD BOLT NUT
1-DH-7	639090	COMMUTATOR PLATE WASHER
1-GAU-31	639085	DRIVE PLATE WASHER
1-GT-78	639087	DRIVE PLATE WASHER
1-DA-39	183344	COMMUTATOR BEARING WASHER
1-DA-22	183345	COMMUTATOR BEARING RETAINING WASHER
1-DA-60	183346	COMMUTATOR BEARING RETAINING WASHER
		SCREW
1-X-199		COMMUTATOR BEARING RETAINING WASHER
		SCREW LOCK WASHER
1-GG-6	639083	DRIVE END BEARING RETAINER
1-GK-176	639086	DRIVE END BEARING INNER FELT WASHER
		RETAINER
1-GT-76	639088	DRIVE END PLATE OUTER FELT WASHER
		RETAINER
3-8X-311	55X19	DRIVE END BEARING RETAINER SCREW
3-X-196	40X377	DRIVE END BEARING RETAINER SCREW
		LOCK WASHER
1-GBJ-32A	183347	COMMUTATOR END PLATE COVER
3-8X870	56X65	COMMUTATOR END PLATE COVER
		FASTENING SCREW
3-12X-544	40X377	COMMUTATOR END PLATE COVER SCREW
		LOCK WASHER
1-GBJ-25	183348	COMMUTATOR END PLATE COVER GASKET
1-GCE-2012S	660837	BRUSH SET
2-8X-305	55X15	GENERATOR BRUSH FASTENING SCREW
2-X-195	40X364	GENERATOR BRUSH FASTENING SCREW
		LOCK WASHER
2-GCE-53	660840	GENERATOR BRUSH SPRING
2-12X-1014	40X432	GENERATOR FRAME SCREW LOCK WASHER

KIT 114 S-599

REPAIR KIT, GENERATOR
CONSISTS OF:

Auto LITE	STUDE.	DESCRIPTION
1-8X-715	55X132	COMMUTATOR SHIELD BOLT
1-8X-794	27X14	COMMUTATOR SHIELD BOLT NUT
1-DH-7	639090	COMMUTATOR PLATE WASHER
1-GAU-31	639085	DRIVE PLATE WASHER
1-GT-78	639087	DRIVE PLATE WASHER
1-DA-22	183345	COMMUTATOR BEARING RETAINING WASHER
1-DA-60	183346	COMMUTATOR BEARING RETAINING WASHER SCREW
1-X-199	40X431	COMMUTATOR BEARING RETAINING WASHER
		SCREW LOCK WASHER
3-8X-311	55X19	DRIVE END BEARING RETAINER SCREW
3-X-196	40X377	DRIVE END BEARING RETAINER SCREW
		LOCK WASHER
3-8X-870	56X65	COMMUTATOR END PLATE COVER FASTENING SCREW
3-12X-544	40X377	COMMUTATOR END PLATE COVER SCREW
		LOCK WASHER
1-GBJ-25	183348	COMMUTATOR END PLATE COVER GASKET
1-GCE-2012S	660837	BRUSH SET
2-8X-305	55X15	GENERATOR BRUSH FASTENING SCREW
2-X-195	40X364	GENERATOR BRUSH FASTENING SCREW
		LOCK WASHER
2-GCE-53	660840	GENERATOR BRUSH SPRING
1-12X-1014	40X432	GENERATOR FRAME SCREW LOCK WASHER

KIT 10A S-515

REPAIR KIT, GENERATOR FIELD COIL.
CONSISTS OF:

Auto-LITE	STUDE.	DESCRIPTION
2-8X-1377	22X34	GENERATOR TERMINAL NUT
2-8X-177	660833	GENERATOR TERMINAL NUT
2-12X-193	40X5	TERMINAL NUT LOCK WASHER
1-GEB-1005A		GENERATOR FIELD COILS
1-8X-1420	904672	FIELD COIL BOLT
1-8X-140		FIELD COIL BOLT NUT
1-12X-194		FIELD COIL BOLT NUT LOCK WASHER
1-8X-349		FIELD COIL TERMINAL NUT WASHER
1-12X-196	40X377	FIELD COIL TERMINAL NUT LOCK WASHER
1-GBW-67	904515	FIELD COIL TERMINAL SQUARE INSULATOR
1-GBW-34	904517	FIELD COIL TERMINAL INSULATING WASHER
1-GCY-25		FIELD COIL TERMINAL INSULATING BUSHING
1-GEB-44		GENERATOR ARMATURE LEAD AND POST
1-8X-361		ARMATURE END TERMINAL WASHER
1-GBW-66	904511	ARMATURE POST INSULATOR
1-GAA-32	904513	ARMATURE POST INSULATING WASHER
1-GC-26		ARMATURE POST INSULATING WASHER
1-GCT-25		ARMATURE POST INSULATING BUSHING
2-GBY-38A	904506	GENERATOR POLE PIECE SCREW
1-GAL-44		FIELD COIL CONNECTOR INSULATOR

ILLUST. NUMBER	PART NUMBER		DESCRIPTION	PER CAR
	MANUFACTURER	STUDEBAKER		
GENERATOR-Cont'd.				
0601-9	AUTO LITE GEB-1005A		FIELD COILS, GENERATOR - WITH TERMINAL POSTS (INCL. IN S-515 KIT)	1
0601-10	X-959	904519	TERMINAL, RIGHT FIELD COIL TO FRAME.	
	8X-1420	904672	BOLT, FLAT HEAD No.6-32X9/16" (INCL. IN S-515 KIT)	
0601-11	8X-140		NUT, HEX. No.6-32 } (INCL. IN S-479, S-515 KITS)	
	12X-194		WASHER, LOCK No.6 } (INCL. IN S-479, S-515 KITS)	
	GEB-58		POST, LEFT FIELD COIL TERMINAL No.10-32X1 5/32"	
	8X-1377	22X34	NUT, HEX. No.10-32 (INCL. IN S-479, S-515 KITS)	
	8X-349		WASHER, PLAIN 13/64" (INCL. IN S-515 KIT)	
	X-196	40X377	WASHER, LOCK No.10 } (INCL. IN S-479, S-515 KITS)	
	GBW-67	904515	INSULATOR, SQUARE } (INCL. IN S-479, S-515 KITS)	
	GBW-34	904517	WASHER, INSULATING } (INCL. IN S-479, S-515 KITS)	
	GCY-25		BUSHING, INSULATING } (INCL. IN S-479, S-515 KITS)	
0601-12	GEB-44		LEAD AND POST, GENERATOR ARMATURE No.14-24X1 1/4"	
	X-847	904509	TERMINAL, ARMATURE END	
	8X-177	660833	NUT, HEX. No.14-24 (INCL. IN S-479 KIT)	
	8X-361		WASHER, PLAIN	
	12X-193	40X5	WASHER, LOCK No.14 (INCL. IN S-479 KIT)	
	GBW-66	904511	INSULATOR, POST	
	3AA-32	904513	WASHER, POST INSULATING 3/4" O.D.	
	GC-26		WASHER, POST INSULATING 9/16" O.D.	
	GCT-25		BUSHING, POST INSULATING	
0601-13	GEB-29		POLE PIECE, GENERATOR	2
	GBY-38A	904506	SCREW, POLE PIECE 3/8"-16X29/32" (INCL. IN S-479, S-515 KITS)	2
	GAL-44		INSULATOR, GENERATOR FIELD COIL CONNECTOR (INCL. IN S-515 KIT)	1
	MN-21	188450	DOWEL, GENERATOR FRAME 1/8"X7/16"	2
0601-15	GCE-24	660843	SHIELD, GENERATOR COMMUTATOR	1
	8X-715	55X132	BOLT, CLAMP No.10-32X1 1/4" } (INCL. IN S-479, S-514 AND S-599 KITS)	
	8X-794	27X14	NUT, SQUARE No.10-32	
0601-16	GEG-2120F	670881	ARMATURE, GENERATOR	1
0601-17	GCE-2118A		PLATE, (WITH BRUSHES) GENERATOR COMMUTATOR	1
0601-18	GCE-1125A		PLATE, (WITH BEARING) GENERATOR DRIVE END	1
0601-19	GCE-125A		PLATE, (LESS BEARING) GENERATOR DRIVE END	1
0601-20	DH-7	639090	WASHER, GENERATOR COMMUTATOR END PLATE - FELT (INCL. IN S-479, S-514 AND S-599 KITS)	1
0601-21	GAU-31	639085	WASHER, GENERATOR DRIVE END PLATE - INNER FELT (INCL. IN S-479, S-514 AND S-599 KITS)	1
0601-22	GT-78	639087	WASHER, GENERATOR DRIVE END PLATE - OUTER FELT (INCL. IN S-479, S-514 AND S-599 KITS)	1
0601-25	N.D.-77503	671319	BEARING, GENERATOR COMMUTATOR END SHIELDED	1
0601-26	DA-39	183344	WASHER, BEARING 1 9/16" O.D. (INCL. IN S-514 KIT)	
0601-27	DA-22	183345	WASHER, RETAINING 13/16" O.D. } (INCL. IN S-514 AND S-599 KITS)	
	DA-60	183346	SCREW, RETAINING WASHER 1/4"-28X5/8"	
	X-199	40X431	WASHER, RETAINING WASHER SCREW LOCK 1/4"	
0601-28	N.D.-77503	671319	BEARING, GENERATOR DRIVE END SHIELDED	1
0601-29	GG-6	639083	RETAINER, BEARING (INCL. IN S-514 KIT)	3
	8X-311	55X19	SCREW, RETAINER No.10-32X3/8" } (INCL. IN S-479, S-514 AND S-500 KITS)	3
	X-196	40X377	WASHER, LOCK No.10	
0601-30	GBJ-32A	183347	COVER, GENERATOR COMMUTATOR END PLATE (INCL. IN S-514 KIT)	1
	8X-870	56X65	SCREW, FASTENING No.10-32X5/16" } (INCL. IN S-479, S-514 AND S-599 KITS)	3
	12X-544	40X377	WASHER, LOCK No.10	3
0601-31	GBJ-25	183348	GASKET, GENERATOR COMMUTATOR END PLATE COVER (INCL. IN S-514 AND S-599 KITS)	1
0601-32	GCE-2012S	660837	BRUSH SET, GENERATOR (CONSISTS OF 2 BRUSHES) (INCL. IN S-514 AND S-599 KITS)	1
	8X-305	55X15	SCREW, FASTENING No.8-32X1/4" } (INCL. IN S-479, S-514 AND S-599 KITS)	2
	X-195	40X364	WASHER, LOCK No.8	2
0601-33	GCE-54	660839	ARM, GENERATOR BRUSH	2
0601-34	GCE-53	660840	SPRING, GENERATOR BRUSH (INCL. IN S-514 AND S-599 KITS)	2
0601-35	DK-23A	660835	SCREW, GENERATOR FRAME (OR THRU BOLT) 5/16"-18X8"	2
	12X-1014	40X432	WASHER, LOCK 5/16" (INCL. IN S-514 AND S-599 KITS)	2

N.D. - NEW DEPARTURE.

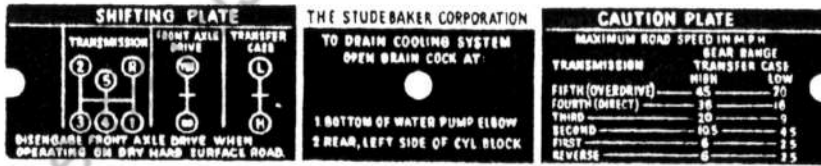

MODEL US6 - CARGO AND SPECIAL CHASSIS - Less Winch

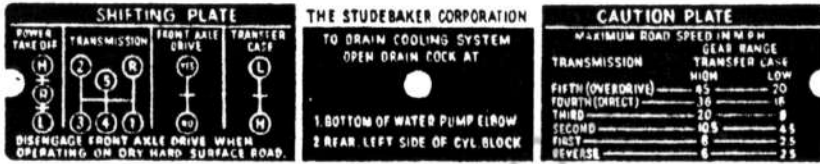

MODEL US6 - CARGO AND SPECIAL CHASSIS - With Winch

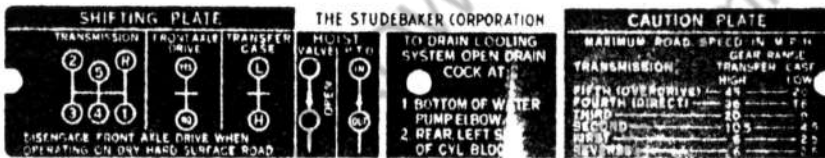

MODEL US6 - DUMP - Less Winch

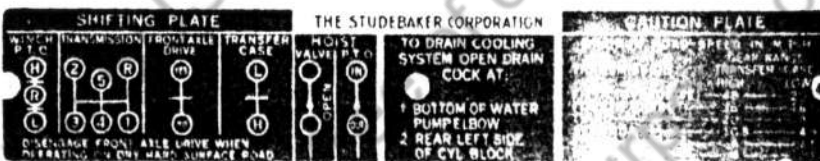

MODEL US6 - DUMP - With Winch

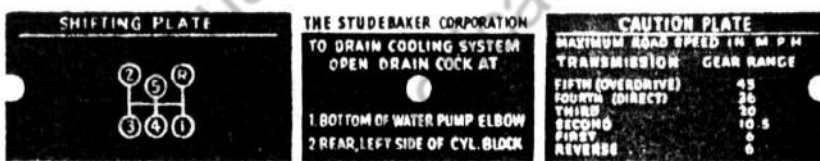

MODEL US6X4 - CARGO and TRACTOR - Less Winch with non-selective transfer case

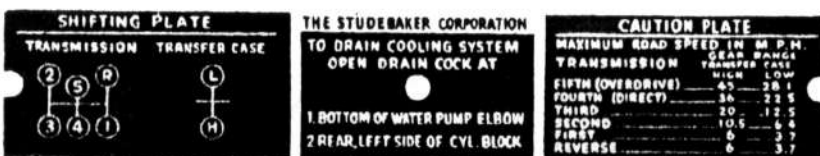

MODEL US6X4 - CARGO and TRACTOR - Less Winch with selective transfer case

The above **SHIFTING AND CAUTION PLATES** are located on left side of instrument board

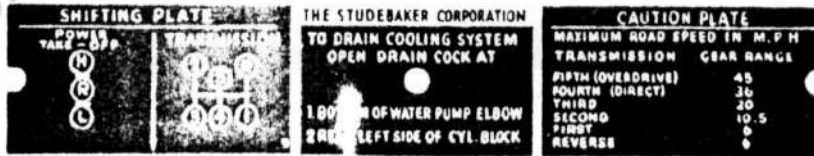

**MODEL US6X4 - CARGO - With Winch
with non-selective transfer case**

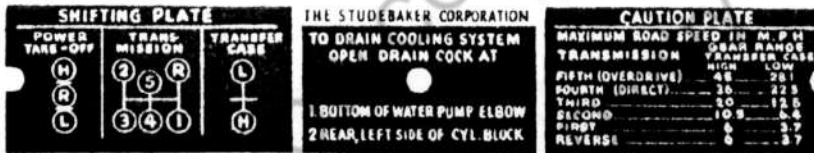

**MODEL US6X4 - CARGO - With Winch
with selective transfer case**

The above **SHIFTING AND CAUTION PLATES** are located on left side of instrument board

WINCH CAUTION PLATE

Located on:

- STEEL TOP CAB: on left door (inside cab)
- SOFT TOP CAB: on left side of instrument board





ENGINE SERIAL PLATE

Located on right side of cylinder block



STFEL TOP CAB

CAB NUMBER PLATES
Located on dash (engine side)

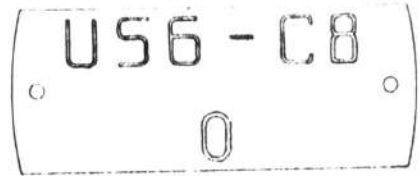

SOFT TOP CAB

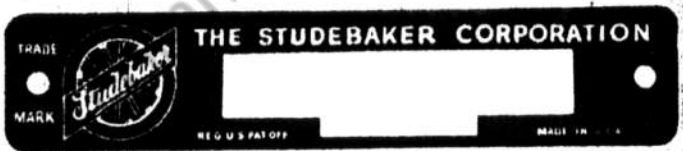

CAR SERIAL NUMBER PLATE

Located on frame under left front fender



PUBLICATION DATA PLATE

Located on:
STEEL TOP CAB: on right side of instrument board
SOFT TOP CAB: on left side of instrument board

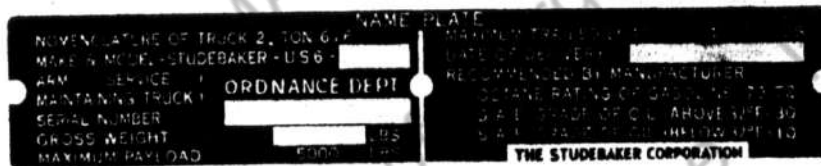

MODEL US6 - CARGO AND SPECIAL CHASSIS

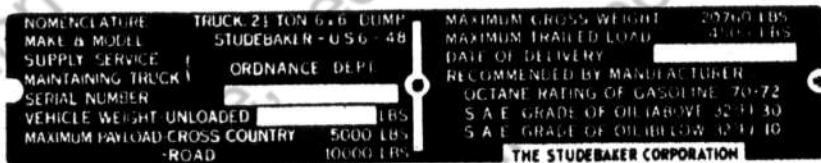

MODEL US6 - DUMP



MODEL US6X4 - CARGO

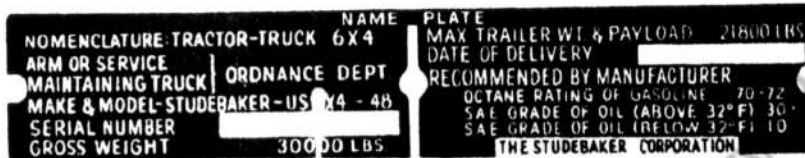

MODEL US6X4 - TRACTOR

The above NAME PLATES are located on right side of instrument board

ILLUST. NUMBER	PART NUMBER		DESCRIPTION	PER CAR
	MANUFACTURER	STUDEBAKER		
1804A- SEAT, CUSHION AND BACK (SOFT TOP CAB)-Cont'd. (Illust. Plate 48)				
1804A-7	651060		BRACKET, SEAT HINGE, RIGHT (BODY HALF)	2
1804A-7	651061		BRACKET, SEAT HINGE, LEFT (BODY HALF)	2
	21X2		NUT, TO SEAT RISER 5/16"-24	12
	41X515		WASHER, PLAIN 5/16"	12
	40X432		WASHER, LOCK 5/16"	12
1804A-8	651427		ARM, PASSENGER SEAT SECTOR	1
1804A-9	651429		BOLT, TO SEAT 5/16"-24X3/4"	1
	41X25		SPACER, TO RISER 1/16" THICK	2
	21X2		NUT, HEX. 5/16"-24	3
	41X515		WASHER, PLAIN 5/16"	1
	84X45		WASHER, SHAKEPROOF 5/16"	2
	651419P		SPRING, PASSENGER SEAT BACK LOCK (FASTENED TO BACK PANEL STRAINER)	1
	13X400		BOLT, TO BODY 1/4"-20X3/4"	2
	20X81		NUT, HEX. 1/4"-20	2
	41X57		WASHER, PLAIN 9/32"	2
	40X431		WASHER, LOCK 1/4"	2
1804A-11	651327		CUSHION, SEAT	2
	651308		COVER, SEAT CUSHION	2
1804A-13	651599		COVER, SEAT BACK (WITH PAD)	2
1804A-13	651537		COVER, SEAT BACK (LESS PAD)	2
	1716XD *		ROPE, SEAT CUSHION COVER TIE	2
	1716XD *		ROPE, SEAT BACK COVER TIE	2

* - LENGTH REQUIRED MUST BE SPECIFIED WHEN USING THIS PART NUMBER.

1805- DOOR, FITTINGS, ETC. (STEEL TOP CAB) (Illust. Plate 47)

THE FOLLOWING PARTS ARE USED EXCLUSIVELY ON STEEL TOP CABS.

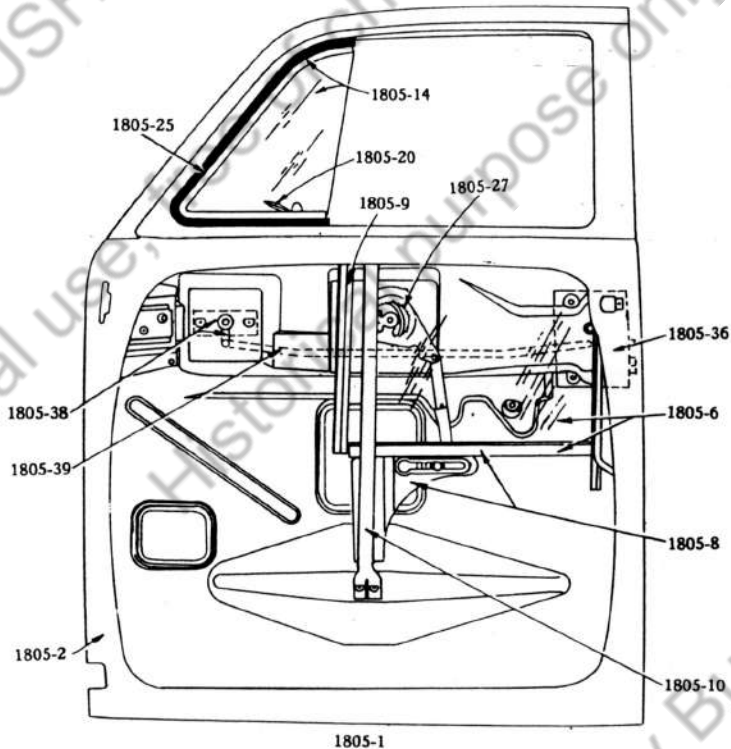

CUT-OUT VIEW OF DOOR SHOWING OPERATING MECHANISM

1805-1	649378	▼ DOOR COMPLETE, RIGHT	1
1805-1	649379	▼ DOOR COMPLETE, LEFT	1

▼ - THIS DOOR IS COMPLETE WITH PAINT, TRIM, GLASS, HINGES AND OPERATING MECHANISM.

ILLUST. NUMBER	PART NUMBER		DESCRIPTION	PER CAR
	MANUFACTURER	STUDEBAKER		

1807- BODY PARTS-Cont'd.

CAB BODY PARTS (STEEL TOP CAB)-Cont'd.

BACK WINDOW

1707XA *	GLASS, BACK WINDOW - SEE GROUP 1809	
	CHANNEL, WINDOW GLASS - 75 3/16" LONG	1
	* - LENGTH REQUIRED MUST BE SPECIFIED WHEN USING THIS PART NUMBER.	
649873	RETAINER, WINDOW GLASS CHANNEL, UPPER	2
649874	RETAINER, WINDOW GLASS CHANNEL, LOWER	2
649875	RETAINER, WINDOW GLASS CHANNEL, SIDE	2
618X3	SCREW, TO CAB No. 8X1/2"	16
1807-18	SCREEN, BACK WINDOW (ILLUST. ON PLATE 45)	1
648578P	SCREW, TO CAB 1/4"-20X5/8"	4
55X141	GASKET, DUCK OR IMITATION LEATHER	4
649863	WASHER, LOCK 1/4"	4
40X431		

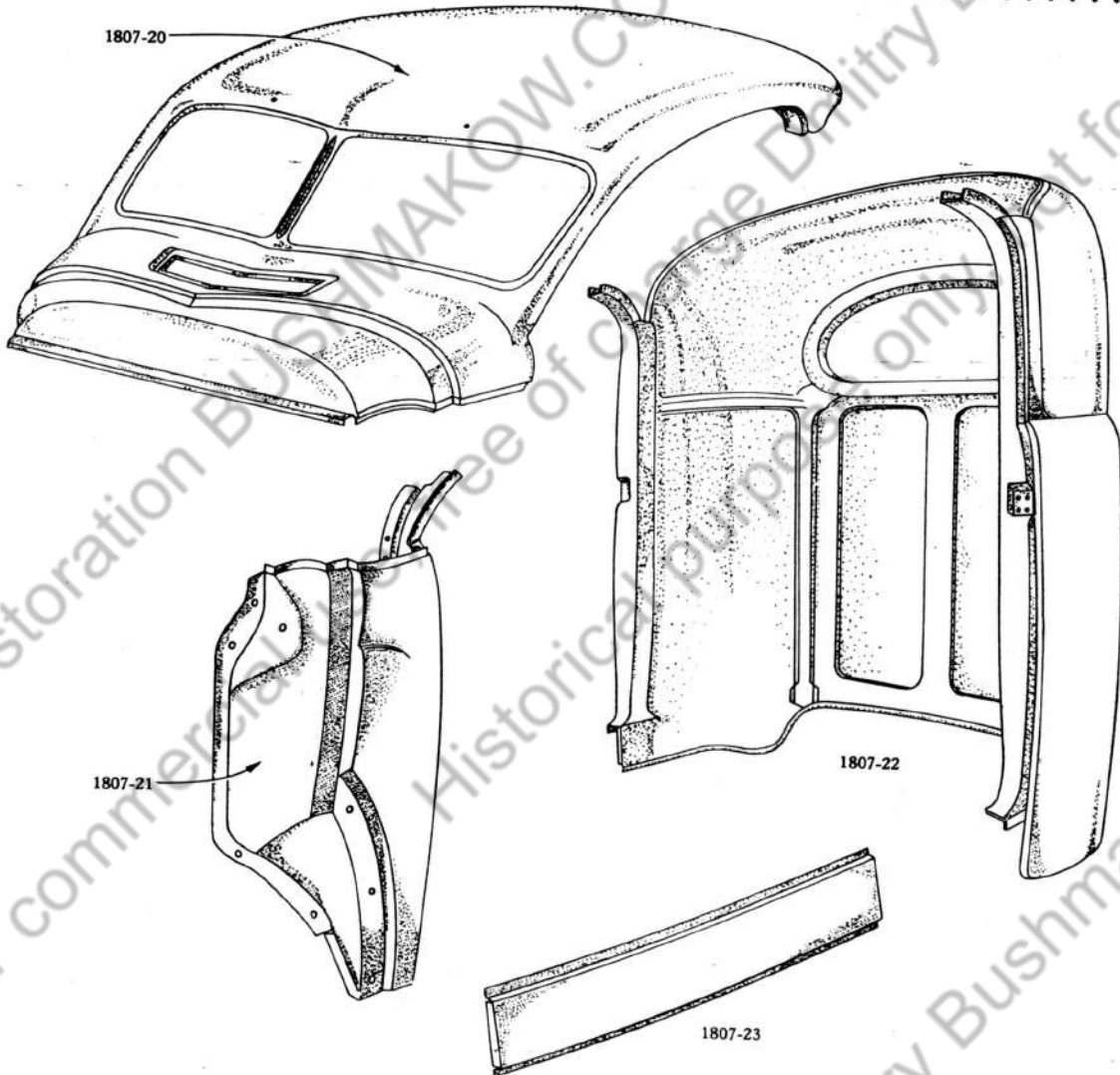

1807-20

649618

BODY PANELS

ROOF PANEL KIT (CONSISTS OF ROOF AND INSULATOR, COWL TOP, W/S HEADER AND COWL CROSS BARS, HINGE PILLAR AND DOOR HEADER REINFORCEMENTS)	1
--	---

ILLUST. NUMBER	PART NUMBER		DESCRIPTION	PER CAR
	MANUFACTURER	STUDEBAKER		

1807- BODY PARTS-Cont'd.

CARGO BODY PARTS (162" W.B.)-Cont'd.

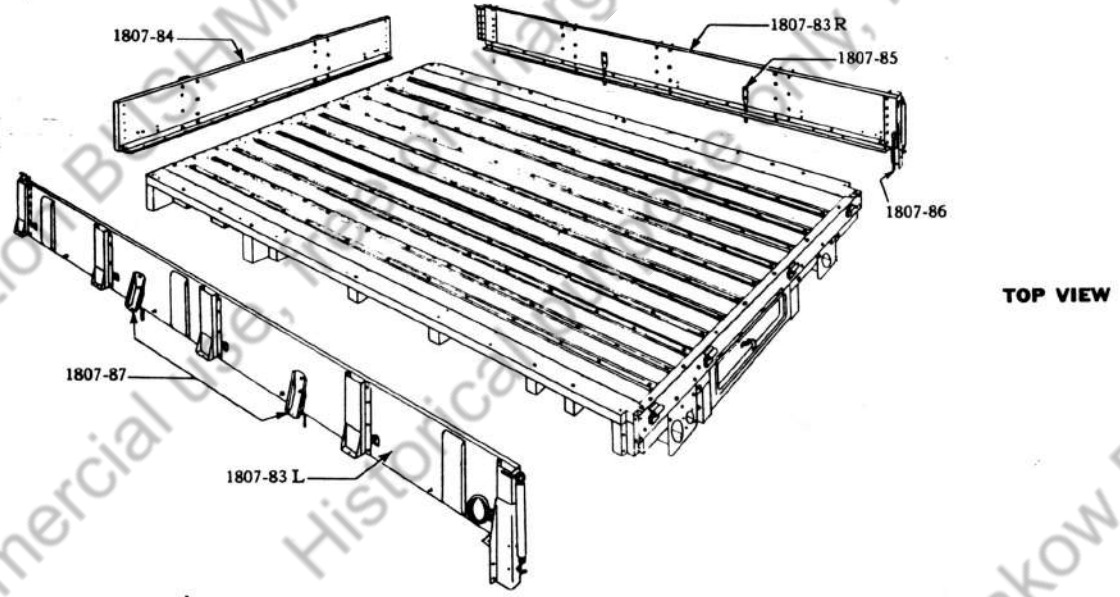
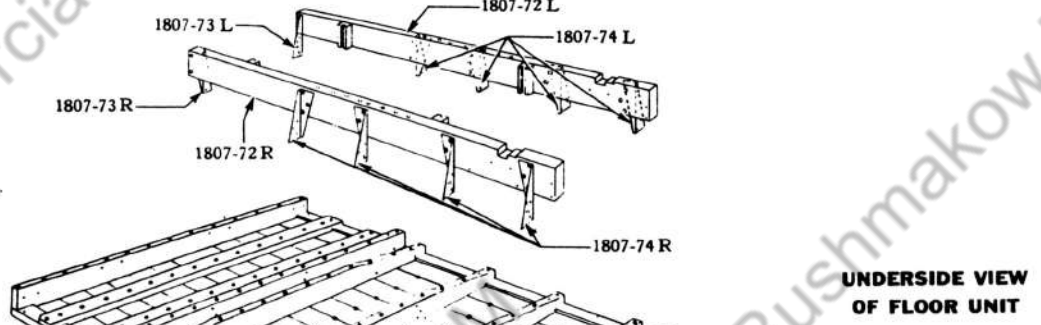

WOOD BODY (80" X 144")

1807-71		651106	FLOOR AND CROSS SILL ASSEMBLY
1807-72		651292	SILL, FLOOR SIDE, RIGHT (LESS BRACKETS)
1807-72		651293	SILL, FLOOR SIDE, LEFT (LESS BRACKETS)
1807-73	E. G. BUDD	651254	BRACKET, SIDE SILL TO #2 CROSS BAR, RIGHT
1807-73	505346	651255	BRACKET, SIDE SILL TO #2 CROSS BAR, LEFT
1807-74	505347	651134	BRACKET, SIDE SILL TO #4-5-6-7 CROSS BAR, RIGHT
1807-74	505348	651135	BRACKET, SIDE SILL TO #4-5-6-7 CROSS BAR, LEFT
	505349	18X88	BOLT, TO #2-6 CROSS BAR 3/8"-16X3"
		18X86	BOLT, TO #4-5 CROSS BAR 3/8"-16X2 1/2"
		18X89	BOLT, TO #7 CROSS BAR 3/8"-16X5 1/2"
		19X356	BOLT, TO #7 CROSS BAR 3/8"-16X5 1/2"
		18X88	BOLT, #2-4-5 BRACKET TO SILL 3/8"-16X3"

ILLUST. NUMBER	PART NUMBER		DESCRIPTION	PER CAR
	MANUFACTURER	STUDEBAKER		

1807A- BODY PARTS-Cont'd. (Illust. Plate 48)

CAB BODY PARTS (SOFT TOP CAB)-Cont'd.

ILLUST. NUMBER	PART NUMBER	DESCRIPTION	LENGTH	PER CAR
1807A-131	1716XC *	ROPE, TOP DECK REAR (ILLUST. ON PLATE 46)	188"	1
1807A-132	1716XB *	ROPE, BACK CURTAIN BOTTOM	120"	1
* - LENGTH REQUIRED MUST BE SPECIFIED WHEN USING THIS PART NUMBER.				
1807A-131	649785	HOOK, TOP DECK REAR ROPE (FASTENED TO BACK AND SIDE PANELS)		3
	1193X16	SCREW, TO BODY 5/16"-24X3/4"		6
	40X432	WASHER, LOCK 5/16"		6
1807A-134	651458	LATCH, SIDE CURTAIN UPPER (ON CURTAIN)		2
1807A-135	651529	LATCH, SIDE CURTAIN LOWER (ON SIDE PANEL)		2
1807A-136	651453	HANDLE, SIDE CURTAIN LATCH		4
	651456	SPRING, HANDLE		4
	651454	RETAINER, SPRING		8
	25X28	NUT, CROWN 1/4"-28		4
	41X517	WASHER, PLAIN - LOWER LATCH 3/8"		2
	40X431	WASHER, LOCK 1/4"		4
	651545	HINGE, SIDE CURTAIN UPPER AND CENTER, RIGHT		2
	651546	HINGE, SIDE CURTAIN UPPER AND CENTER, LEFT		2
	651547	HINGE, SIDE CURTAIN LOWER, RIGHT		1
	651548	HINGE, SIDE CURTAIN LOWER, LEFT		1
	55X21	BOLT, TO CURTAIN No. 10-24X1/2"		12
	24X44	NUT, HEX. No. 10-24		12
	40X365	WASHER, LOCK No. 10		12
1807A-141	651098	BRACKET, SIDE CURTAIN UPPER HINGE - WELDED TO WINDSHIELD FRAME		2
1807A-142	651388	BRACKET, SIDE CURTAIN CENTER HINGE - WELDED TO WINDSHIELD FRAME BRACKET		2
1807A-143	651412	BRACKET, SIDE CURTAIN LOWER HINGE, RIGHT } WELDED TO BODY		1
1807A-143	651413	BRACKET, SIDE CURTAIN LOWER HINGE, LEFT } SIDE PANEL		1

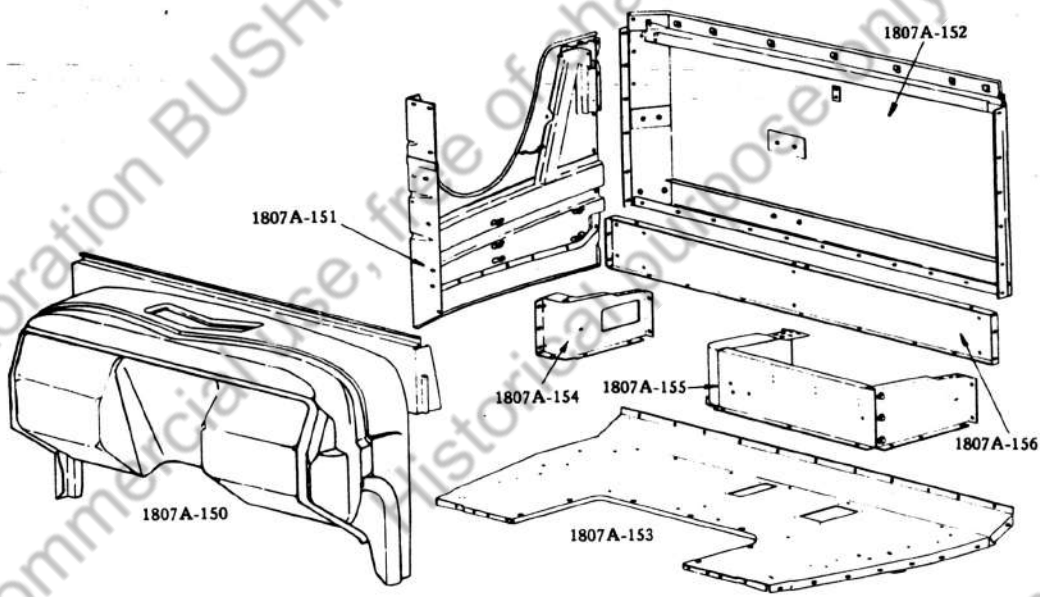

BODY PANELS

1807A-150	651420	FRONT END ASSEMBLY (CONSISTS OF DASH, COWL TOP, COWL SIDES, INSTRUMENT BOARD AND REINFORCEMENTS)		1
1807A-151	651390	PANEL, BODY SIDE, RIGHT	COMPLETE WITH ALL REINFORCEMENTS	1
1807A-151	651391	PANEL, BODY SIDE, LEFT		1
1807A-152	651384	PANEL, BODY BACK		1
	11X4	BOLT, TO COWL - UPPER 5/16"-24X7/8"		4
	57X143	BOLT, TO COWL - UPPER 1/4"-20X3/4"		2
	11X175	BOLT, TO COWL - CENTER 1/2"-20X1 1/2"		6
	11X158	BOLT, TO COWL - LOWER 5/16"-24X1 1/4"		2
	11X4	BOLT, SIDE TO FLOOR PAN 5/16"-24X7/8"		16